

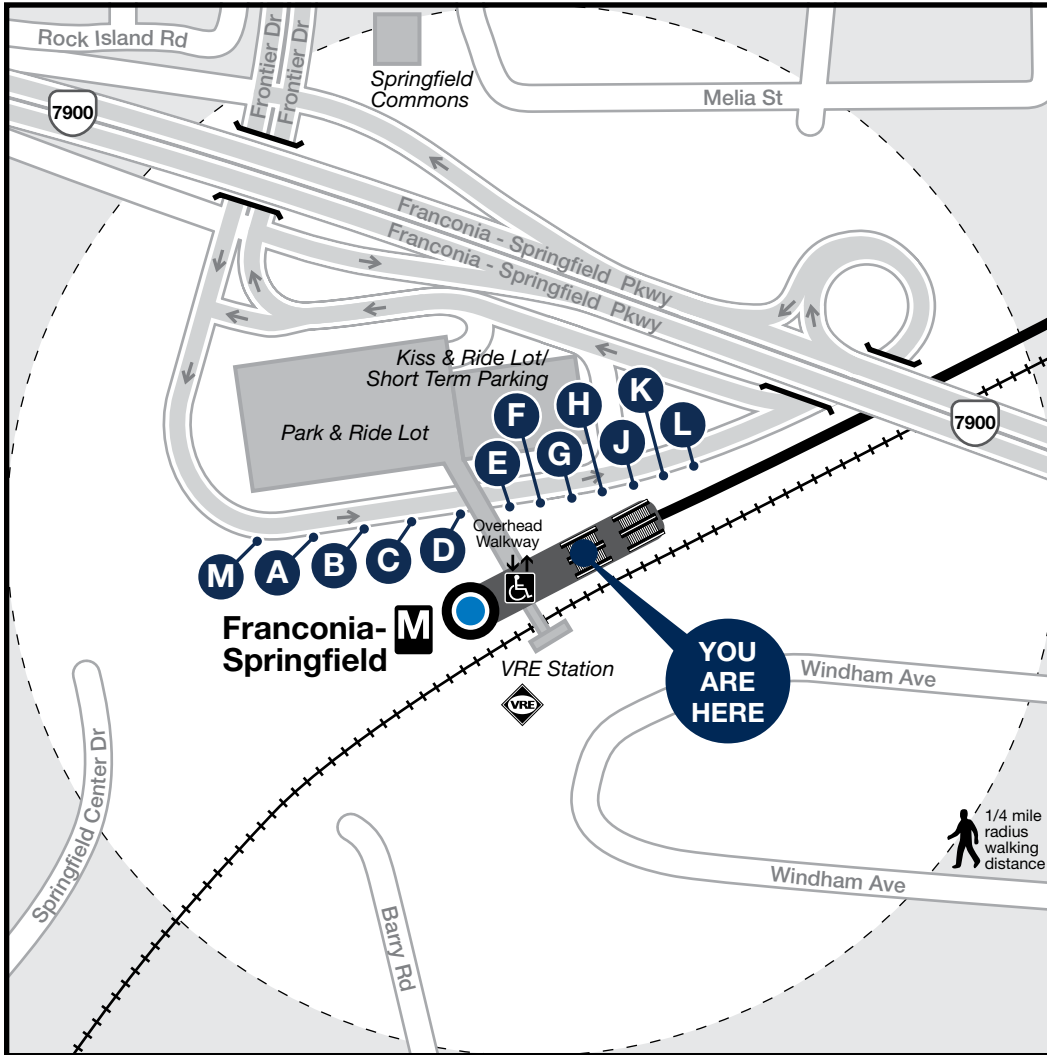

# Station Vicinity Map Franconia-Springfield



### LEGEND

**A A** Bus Stop/Bus Bay  
The lettered discs on this map will help you locate the bus stop or bay near this station. Be advised the letters are not displayed on the street bus stops

Elevator  
 Escalator  
 Bus Route  
 Metrorail Station and line

86.EVAC-0519

**Metrobus SHUTTLE**

During the May 25–September 8 Platform Improvement Project, shuttle bus service will be provided to connect the closed Blue Line stations as well as bypass the project area.

**C Blue Line Shuttle**  
to Van Dorn St **M**,  
King St-Old Town **M**,  
Old Town Alexandria, and  
Reagan National Airport **M**

**D Franconia-Pentagon Express**  
Express service to the Pentagon

## APPROXIMATE WALKING DISTANCE TO THE NEXT METRO STATION FROM THIS EXIT

Station	Lines	Distance	Time to Station	Directions
There are no stations within a reasonable walking distance.				

## BUS SERVICE AND BOARDING LOCATIONS

Route	Destination	Stops	Route	Destination	Stops	Route	Destination	Stops
<b>METROBUS</b>			<b>310</b>	Rolling Valley Park & Ride	<b>F</b>	<b>401</b>	Tysons West*Park	<b>E</b>
<b>S80</b>	TAGS – Metro Park	<b>C</b>	<b>310</b>	Huntington <b>M</b>	<b>H</b>	<b>494</b>	Tysons-Spring Hill <b>M</b>	<b>L</b>
<b>S80</b>	TAGS – Springfield Hilton	<b>D</b>	<b>321</b>	Van Dorn St <b>M</b> (Counterclockwise)	<b>H</b>	<b>494</b>	Lorton VRE Station	<b>L</b>
<b>S91</b>	TAGS – Springfield Town Center	<b>D</b>	<b>322</b>	Van Dorn St <b>M</b> (Clockwise)	<b>F</b>	<b>BESTBUS</b> <b>M</b>		
<b>FAIRFAX CONNECTOR – FAIRFAX CO</b>			<b>333</b>	Saratoga Park & Ride	<b>J</b>	<b>OMNIRIDE</b>		
<b>231</b>	Van Dorn St <b>M</b> (Counterclockwise)	<b>K</b>	<b>334</b>	DLA/Gateway 95	<b>J</b>	<b>OMNIRIDE</b> OmniRide Transit Center <b>B</b>		
<b>232</b>	Van Dorn St <b>M</b> (Clockwise)	<b>K</b>	<b>335</b>	Fort Belvoir	<b>J</b>	<b>GREYHOUND</b> <b>A</b>		
<b>301</b>	Huntington <b>M</b>	<b>L</b>	<b>371</b>	Lorton Park & Ride	<b>G</b>			
<b>305</b>	Lorton VRE Station	<b>L</b>	<b>372</b>	Lorton Park & Ride	<b>G</b>			
<b>308</b>	Mt Vernon Hospital	<b>L</b>	<b>373</b>	Laurel Crest	<b>G</b>			

Subject to change without notice. Esta información puede cambiar.

