

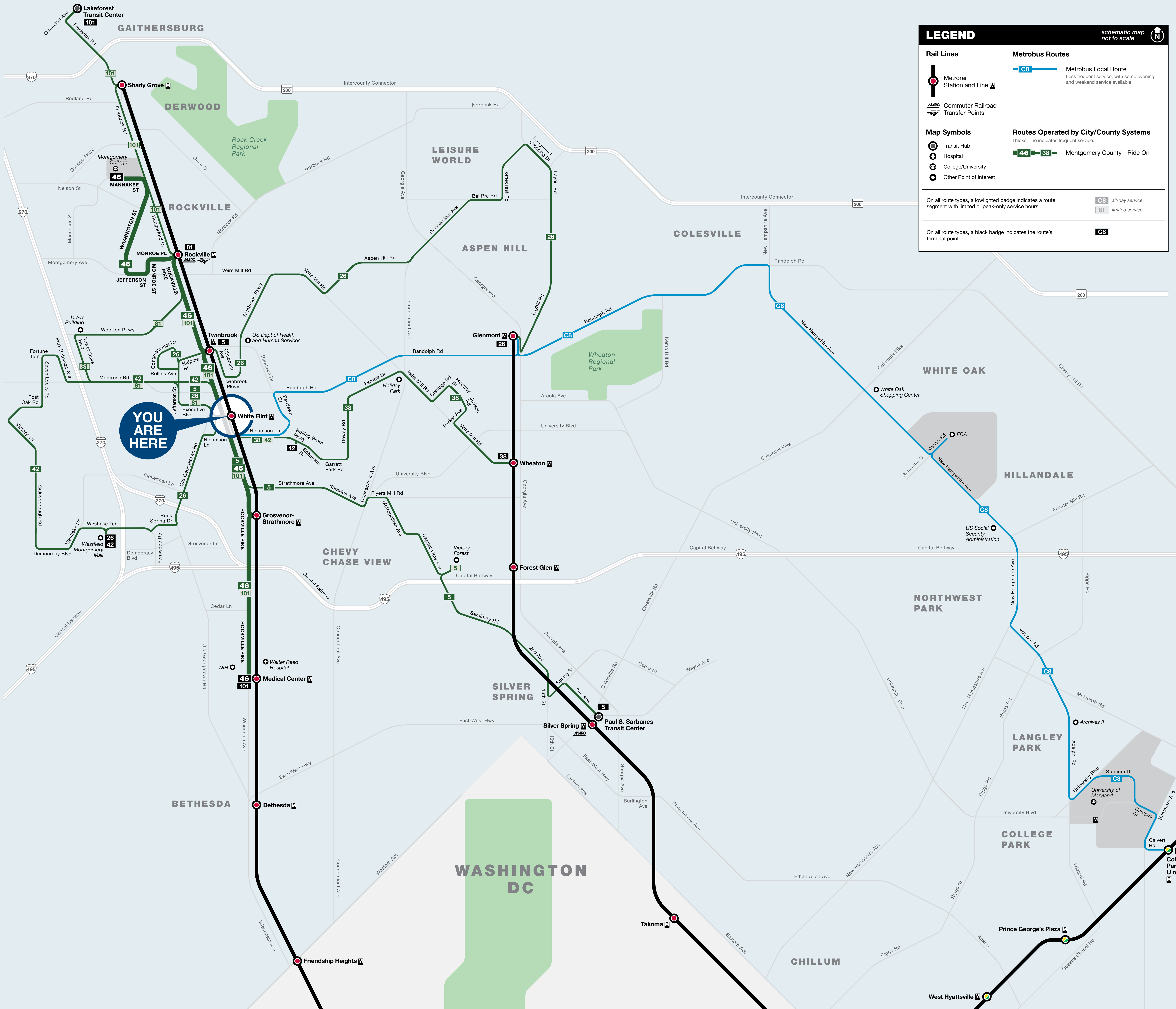

Bus Service from White Flint



LEGEND

Rail Lines

- MetroRail Station and Line
- Commuter Railroad Transfer Points

Map Symbols

- Transit Hub
- Hospital
- College/University
- Other Point of Interest

Metrobus Routes

- C8** Metrobus Local Route: Less frequent service, with some evening and weekend service available.
- 46-81** Montgomery County - Ride On

Routes Operated by City/County Systems

- CG** all-day service
- BT** limited service
- CA**

On all route types, a lighted badge indicates a route segment with limited or peak-only service hours.
On all route types, a black badge indicates the route's terminal point.

BUS SERVICE AND BOARDING LOCATIONS

The table shows approximate minutes between buses; check schedules for full details

ROUTE	DESTINATION	BOARD AT BUS STOP	MONDAY TO FRIDAY				SATURDAY		SUNDAY	
			AM RUSH	MIDDAY	PM RUSH	EVENING	DAY	EVENING	DAY	EVENING
COLLEGE PARK-WHITE FLINT LINE										
C8	College Park-U of Md	A	30	30	30	30 [^]	30 [^]	30 [^]	--	--
RIDE ON-MONTGOMERY COUNTY										
5	Paul S. Sarbanes Transit Center (Silver Spring)	C	20	20-35*	15-20	35-40	40*	40	40*	40
5	Twinbrook	B	15	35	25	35-45	40	40	40	40
26	Glenmont	B	20-25	25-30	20	25-45	35	35-45	35	35-45
26	Montgomery Mall Transit Center	C	20-25	25-30	20	25-45	35	35-45	35	35-45
38	Wheaton	A	30	30	30	30-35	35	35	35	--
42	Boiling Brook Pkwy	A	1 trip	--	--	--	--	--	--	--
42	Montgomery Mall Transit Center	A B	40	40	40	--	40	--	--	--
46	Medical Center	C	20	15-20	15	20-40	25-35	30-40	30-40	40
46	Montgomery College	B	20	15-20	15	20-40	25-35	30-40	30-40	40
81	Rockville	A B	35	--	35	--	--	--	--	--
101	Lakeforest Transit Center	B	15	--	15	--	--	--	--	--
101	Medical Center	C	15	--	15	--	--	--	--	--

Metrobus SHUTTLE

B toward Twinbrook
B toward Grosvenor-Strathmore
C

During track work and/or rail shutdown events, this bus stop will also be served by Metro shuttle buses.

NOTE: The lettered red discs in the table and on the boarding map identify bus stops near this station. The letters ARE NOT displayed at the actual bus stops.
[^] C8 does not serve FDA/FRC Monday to Friday in the evenings or on the weekends.
 * Trip also serves Victory Forest (formerly Leaky House). See route schedule for details.

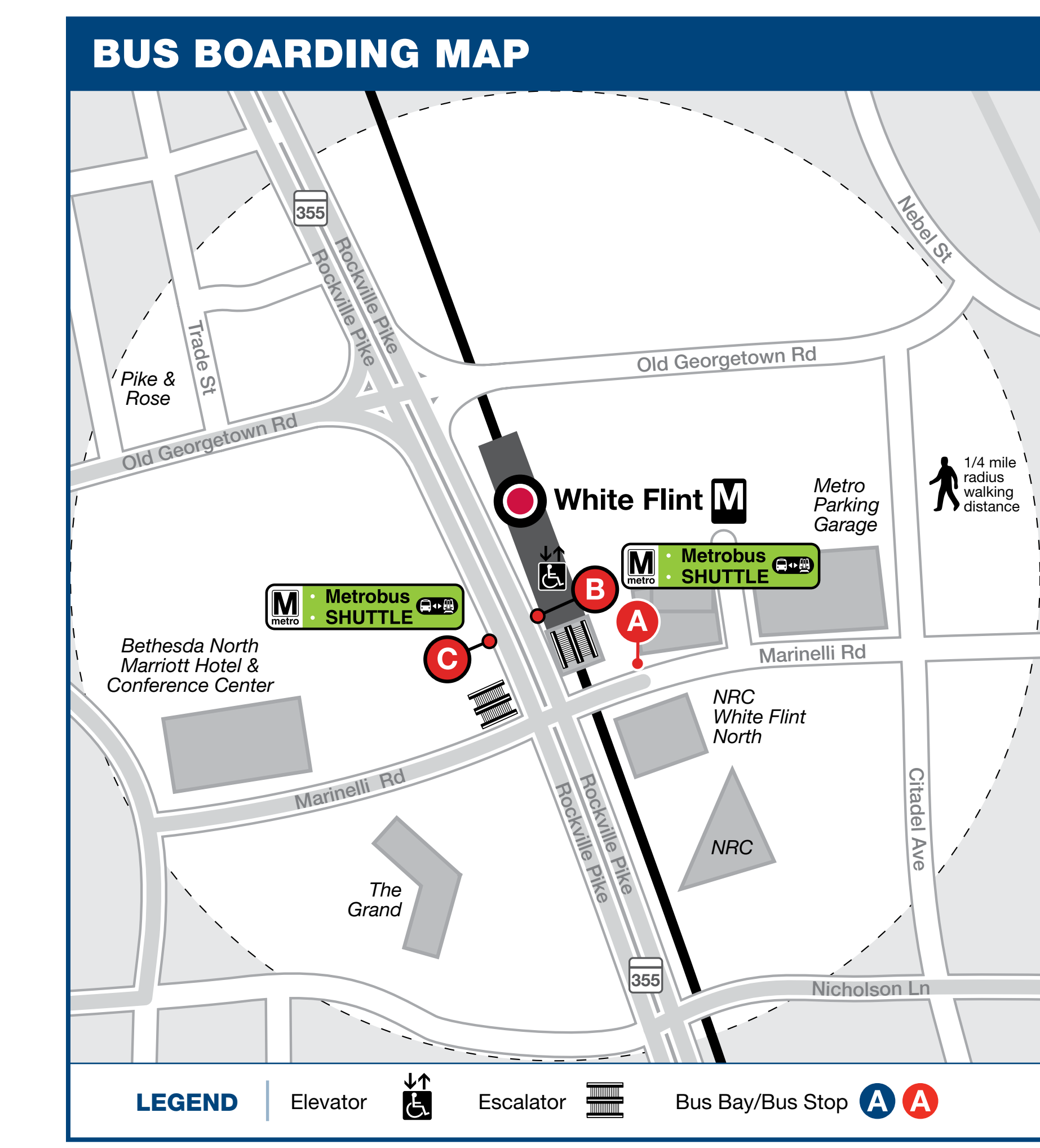

Bus service is subject to change. Check wmata.com for updates.

metroAlerts

Through MetroAlerts, you can be notified of Metro service disruptions via email or text messages. MetroAlerts can be sent to computers, cellular phones, pagers or personal digital assistants capable of receiving data. MetroAlerts are limited to 140 characters to prevent them from being truncated when received as text messages. If further information on the incident is available, it is published on the website and a link to that information is included in the MetroAlert.

KNOW MORE. KNOW FIRST.
Sign up today at wmata.com/MetroAlerts

information wmata.com | PHONE 202-637-7000 | TTY 202-638-3780
 busETA and General Inquiries Para busETA y información general, llame al 202-637-7000 (TTY 202-638-3780) o visite wmata.com.

metroAlerts
 Sign up today at wmata.com/MetroAlerts

Metro is accessible. Metro es accesible. 메트로는 접속 가능합니다.