

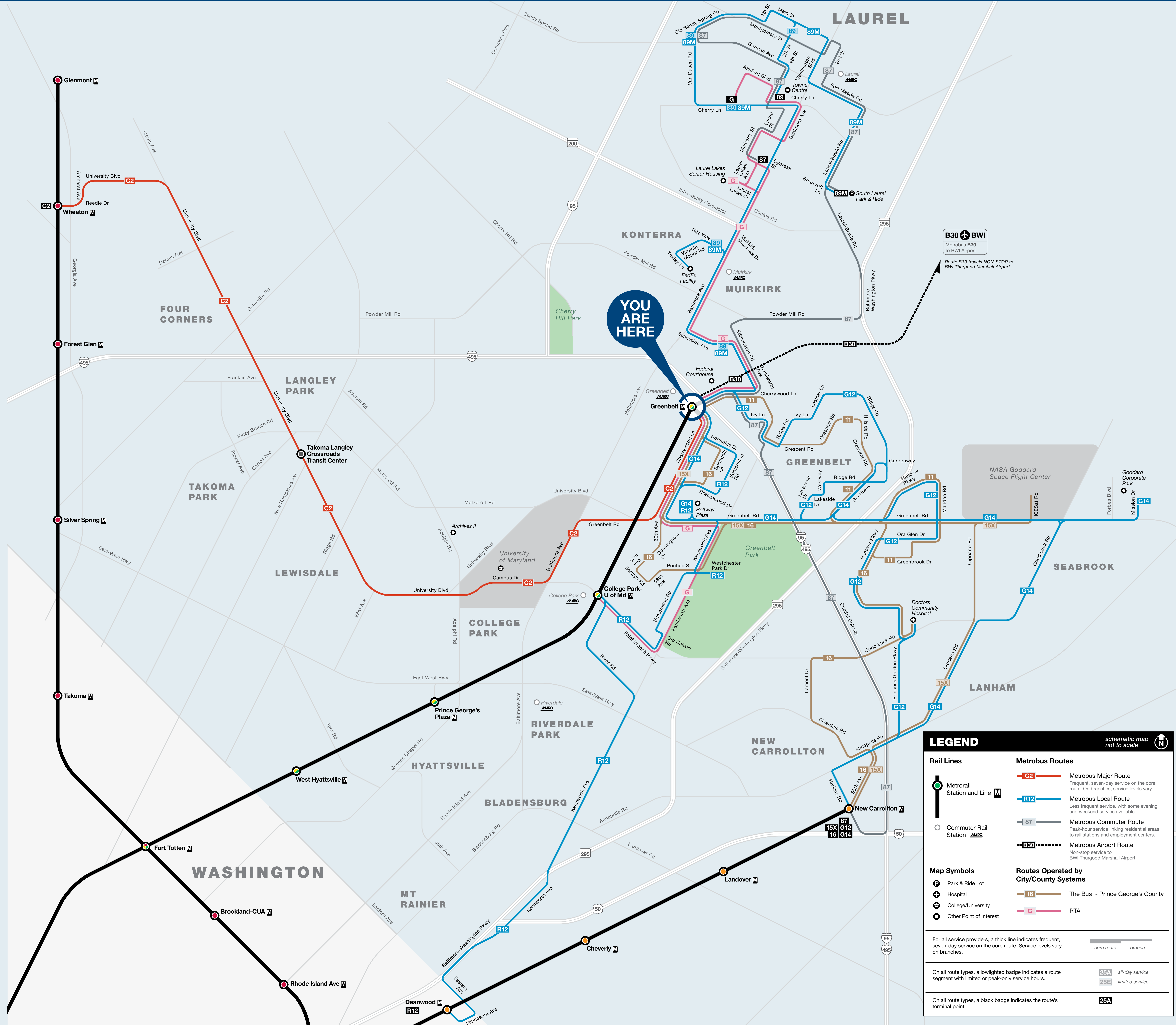

Bus Service from Greenbelt



BUS SERVICE AND BOARDING LOCATIONS

The table shows approximate minutes between buses; check schedules for full details

ROUTE	DESTINATION	BOARD AT BUS BAY	MONDAY TO FRIDAY				SATURDAY		SUNDAY	
			AM RUSH	MIDDAY	PM RUSH	EVENING	DAY	EVENING	DAY	EVENING
LAUREL EXPRESS LINE										
87	Laurel	C	25-45	--	15-30	--	--	--	--	--
87	New Carrollton	C	40	--	--	--	--	--	--	--
LAUREL LINE										
89	Laurel	C	40-55	--	50	60	--	--	--	--
89M	South Laurel Park & Ride	C	--	60	--	--	--	--	--	--
BWI THURGOOD MARSHALL AIRPORT LINE										
B30	BWI Thurgood Marshall Airport	D	40	40	40	40	40	40	40	40
UNIVERSITY BLVD LINE										
C2	Wheaton	G	12-24	20-30	20	30*	24	30*	45**	--
GREENBELT-NEW CARROLLTON LINE										
G12	New Carrollton	E	30	60	30	60*	60	60	60	60
G14	New Carrollton via Goddard	F	30***	60	30	60	60	60	60	60
KENILWORTH AVE LINE										
R12	Deanwood	F	30^	60	30	60	60	60	--	--
THE BUS-PRINCE GEORGE'S COUNTY										
11	Greenway Center	E	30	30	30	30	--	--	--	--
15X	New Carrollton via NASA	A	40	--	40	--	--	--	--	--
16	New Carrollton via Lamont Dr	A	30	60	30	--	--	--	--	--
RTA OF CENTRAL MARYLAND										
G	Laurel	C	--	--	--	--	60	--	60	--
G	College Park-U of Md	C	--	--	--	--	60	--	--	--
M	Metrobus SHUTTLE	G	During track work and/or rail shutdown events, this bus stop will also be served by Metro shuttle buses.							

* Trips after 8:35 pm continue to Randolph Rd & Lauderdale Dr.
 ** Trips terminate at Takoma Langley Crossroads Transit Center.
 ^ Weekday trips before 8:30 am do not serve Beltway Plaza.
 *** Weekday Trips before 7:15 am do not serve Beltway Plaza.
 • Late night trips end at Roosevelt Center.

BUS BOARDING MAP

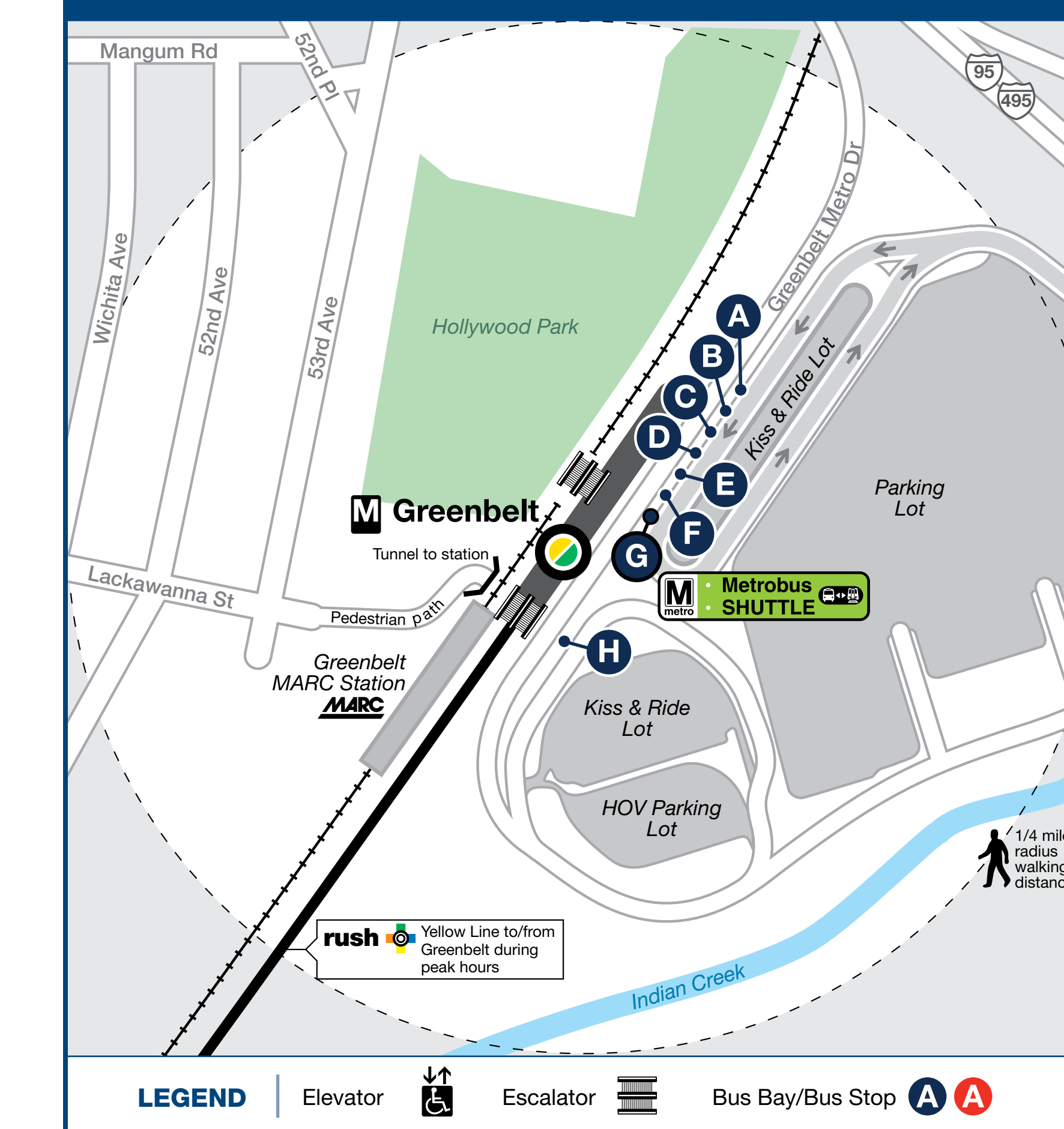

metroAlerts

Through MetroAlerts, you can be notified of Metro service disruptions via email or text messages. MetroAlerts can be sent to computers, cellular phones, pagers or personal digital assistants capable of receiving data. MetroAlerts are limited to 140 characters to prevent them from being truncated when received as text messages. If further information on the incident is available, it is published on the website and a link to that information is included in the MetroAlert.

KNOW MORE. KNOW FIRST.
 Sign up today at wmata.com/MetroAlerts

information wmata.com | 202-637-7000 | 202-638-3780

busETA and General Inquiries

Para busETA y información general, llame al 202-637-7000 (TTY 202-638-3780) o visite wmata.com.

정보나 busETA 또는 언어 지원 관련 문의는 202-637-7000 (TTY 202-638-3780) 으로 전화하십시오. 스페인어 문의는 7을 누르시고, 기타 언어 관련 문의는 88을 누른 후 5를 누르십시오. 또는 wmata.com 을 방문하십시오.

metroAlerts
 Sign up today at wmata.com/MetroAlerts

Metro is accessible.
 Metro es accesible.
 메트로는 접속 가능합니다.

