

Bladensburg Bus Garage Reconstruction Project



Spring Community Engagement Meeting
Washington Metropolitan Area Transit Authority
May 21, 2026

This meeting is being recorded

Meeting Etiquette: Virtual

Help keep this meeting productive and respectful.

There are two options available to ask questions:



Type questions directly into the Q&A tool

Use the raise hand feature in Zoom
To raise your hand while dialing in, **press *9**

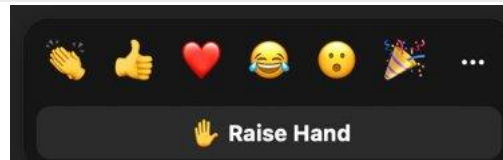

When speaking:



Maintain a civil tone

Be mindful of time

All questions will be addressed at the end of the presentation.

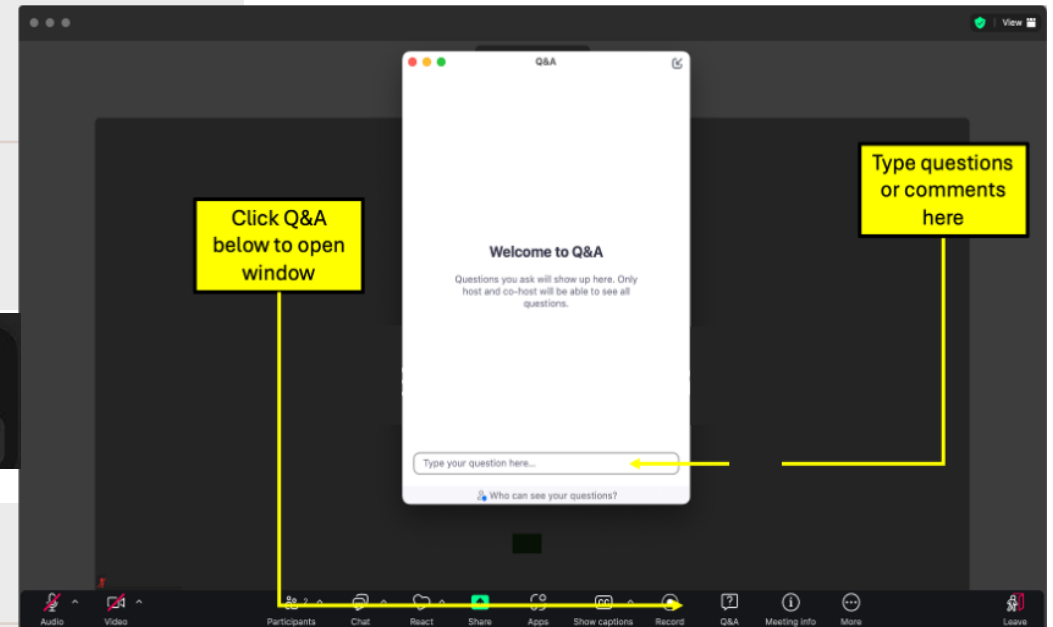

Meeting Etiquette: In-Person

Help keep this meeting productive and respectful:

Please adhere to the Q&A protocol:



Type questions directly into the Q&A tool



Speak clearly into the microphone



Allow presenters, and those speaking, to finish

When speaking:



Maintain a civil tone

Be mindful of time

Agenda



Introductions



Project Overview and Updates



Construction Updates



Art in Transit



A Look Ahead



Introductions

Project Team



Maya Nino
Director, Bus Garages
Project Delivery



Shaun Pratt
Project Manager



**Jameelah
Muhammad Ingram**
Commercial Manager



Nicholas Tomaine
Project Manager
Hensel Phelps

Project Team



Jim Ashe
Environmental
Coordinator



Anne Delaney
WMATA, Acting
Project Manager, Art
in Transit

Project Overview and Updates

Review of Last Meeting

- Fall community meeting: October 21, 2025
- Topics discussed included:
 - Project Overview and Updates
 - Phase 1 Completion: July 2025
 - Phase 2 Commencement: August 2025
 - Construction Progress Photos
 - Construction Schedule
 - Questions and Answers
- All community meeting resources available in the "Project Updates" section of the project webpage:

wmata.com/BladensburgBusGarage



Project Overview

- Reconstruction of site includes:
 - New maintenance facility (Complete)
 - Parking for 292 buses
 - Charging infrastructure and equipment to support battery-electric buses (BEB)
 - 50 battery-electric bus charging stations (post Aug. 2027)
 - Parking structure for 440 employees
- Project Schedule:*



* As BEB design continues, WMATA will evaluate any impacts to the overall schedule. Schedule excludes BEB Construction.

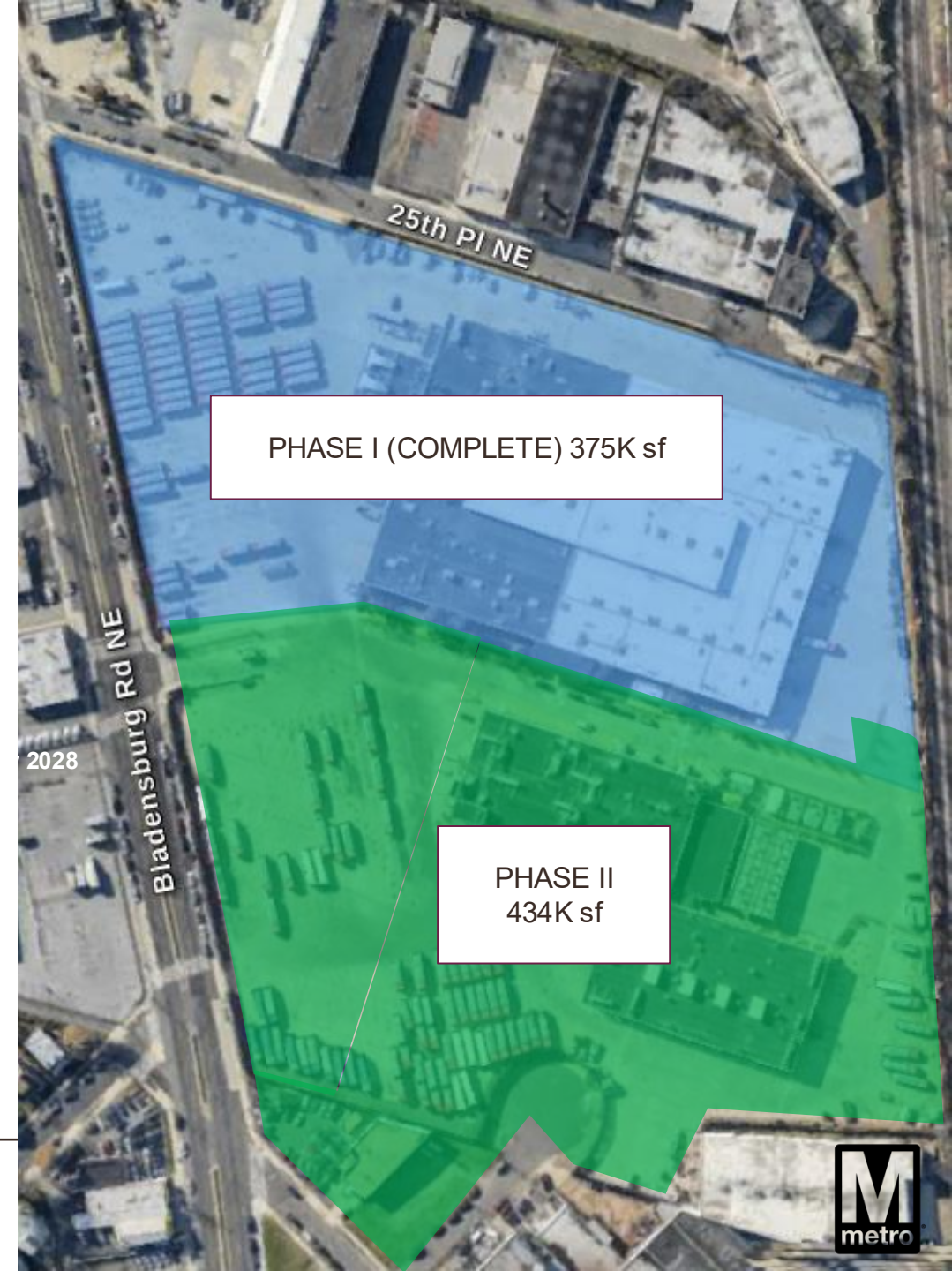

Best Practices for Cleanliness & Noise Control During Construction

- Required daily work area clean up
- Stationed waste receptacles (1)
- Department of Energy & Environment (DOEE) approved water runoff controls (2)
- Dust control (3)
- Wash construction vehicle wheels (4)
- Onsite street sweeper
- Weekly trash pick-up
- Monitoring & maintenance of vegetation
- Typical weekday crew hours: 7 a.m. – 7 p.m.
- Limited hours for oversized deliveries: 9:30 a.m. – 3 p.m.

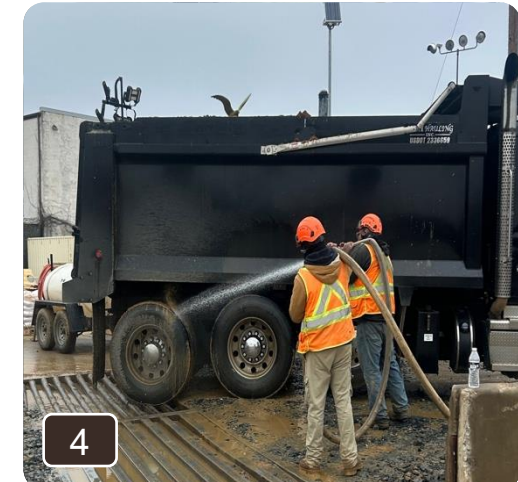

Construction Traffic Flow and Contractor Parking

- Designated areas for contractor personal vehicle parking:

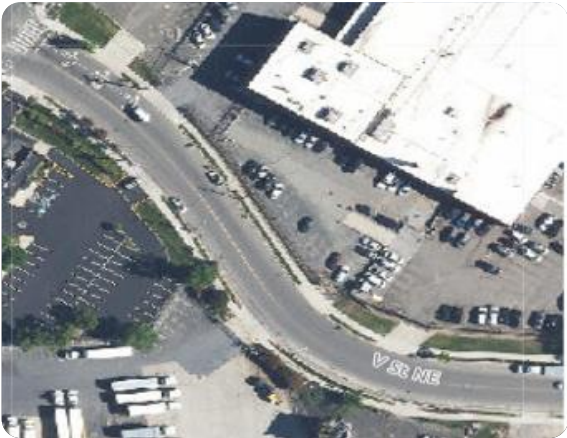

V St NE

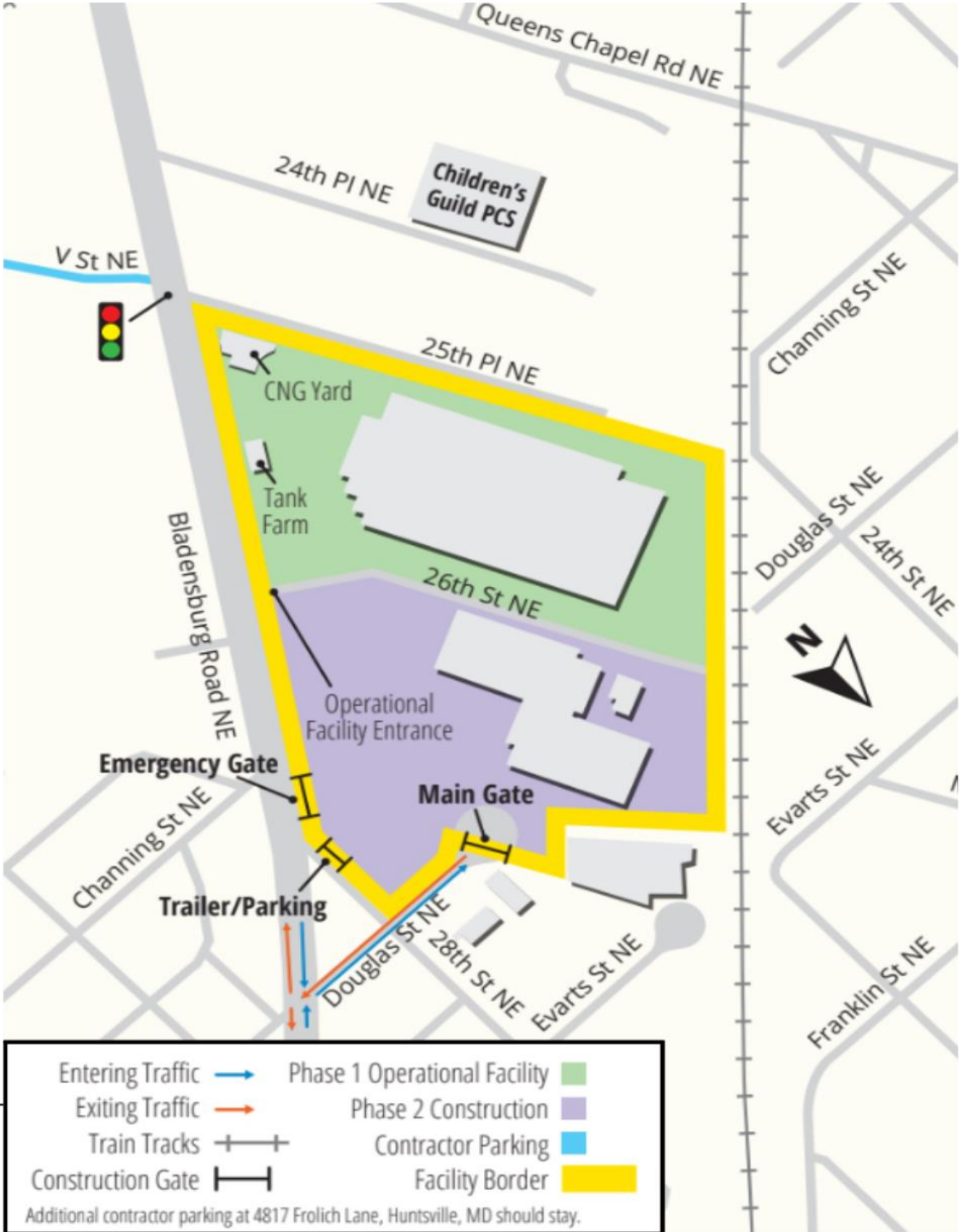

Agency Collaboration & Permitting Status

Agency	Status
Federal Transit Administration (FTA)	Categorical exclusion granted (summer 2020)
District Department of Transportation (DDOT) Infrastructure Project Management Administration (IPMA)	Completed legislative process to close Douglas St. NE cul-de-sac in winter 2025 Public Space Committee Hearing anticipated in May 2026 Maintenance of Traffic (MOT) coordination for Channing Street/Signalized Entrance
District of Columbia State Historic Preservation Office (DC SHPO)	Programmatic Agreement (winter 2020) Completed Draft Archaeological Management Summary report: <i>Conditional finding of No Adverse Effect to Historic Properties per FTA</i>
District of Columbia Department of Energy and Environment (DOEE)	Phase 1 stormwater management drawings approved (winter 2022) Comprehensive Site Assessment (CSA) Work Plan & Leaking Underground Storage Tank (LUST) Case
DC Water	Completed water connection to Maintenance Building (fall 2024) Phase 2 and Phase 3 plans approved (spring 2025) Coordination ongoing for Phase 2 Construction
Pepco	Coordination ongoing for Phase 2 Construction and BEB design
Washington Gas	New gas line installed for Compressed Natural Gas (CNG) Yard (fall 2024) Setting above ground pipework for new gas line (fall 2024) Coordination ongoing for Phase 2 Construction
Department of Buildings (DOB)	Completed raze of acquired properties (summer 2024) Parking Garage Building Permit approved (fall 2025) Coordinating design revisions for Green Area Ratio (GAR)

Construction Updates

Phase 2 Demo Activities – Progress

Demolition of Existing Structure & Utilities



Building Demolition



Removal & Haul-out of
Underground Storage
Tanks (USTs)



Demolition of Underground
Stormwater Retention Tanks

Phase 2 Underground Activities – Progress

Building Pad Prep & Auger Cast-In-Place Piles (ACP)



February 10, 2026



February 10, 2026



February 28, 2026



February 28, 2026



February 24, 2026

Phase 2 Underground Activities – Progress

Pile Caps, Sand Filters,
Foundation Walls, Columns



March 17, 2026



April 7, 2026



April 21, 2026

Phase 2 Douglas St. Activities – Future Work

Cul-De-Sac Improvements

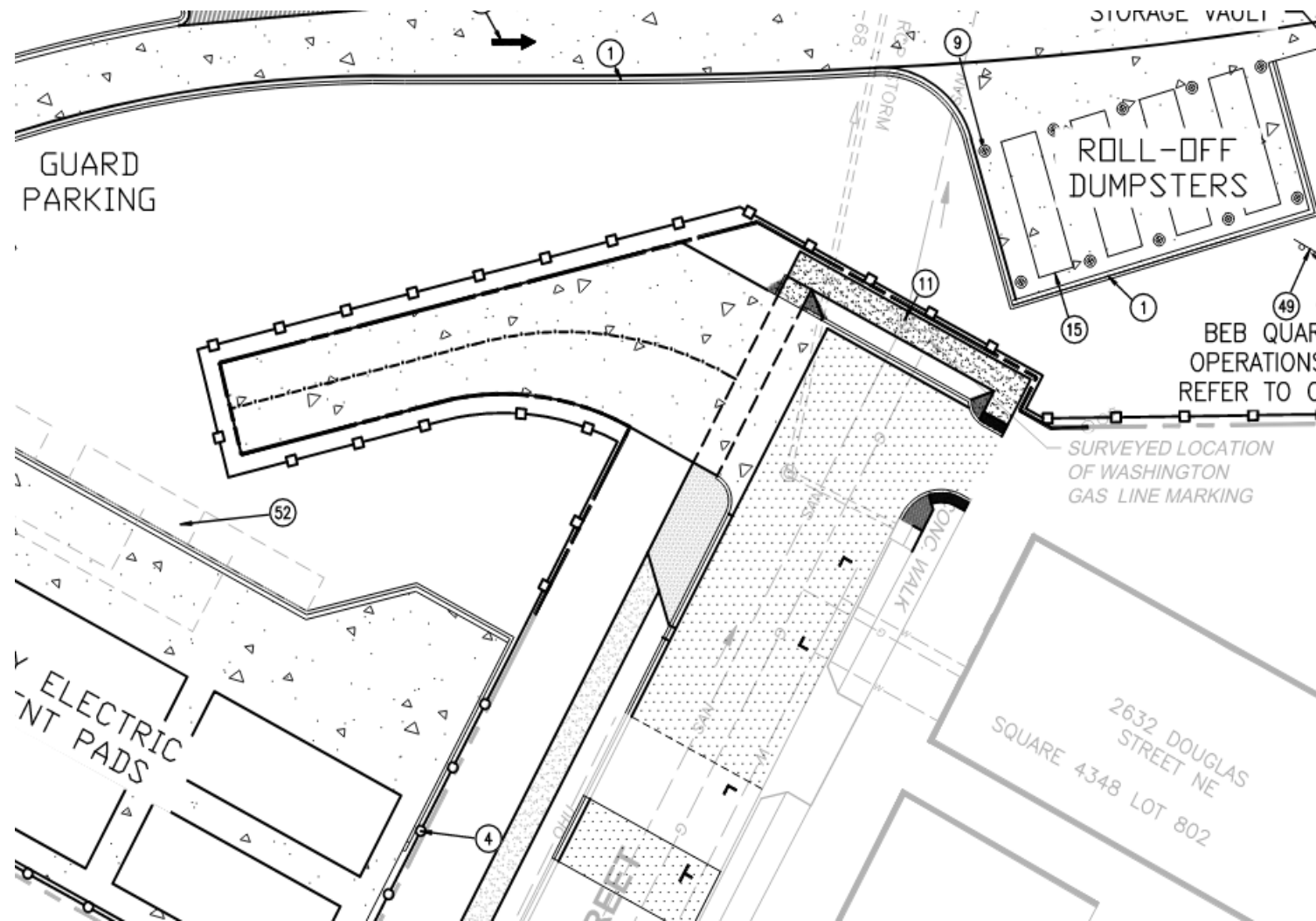

Douglas St. New Site Layout ~ October '26 Completion Time

Art in Transit

Art in Transit

Artwork Location:

- Area at the new main entrance of the Bladensburg Bus Garage facility.
- The location provides a high level of visibility.

Call for Artists:

- Launch in late July/early August 2026.
- Call will be open to artists living in the DMV area.
- An Art Selection Panel will include up to five members notably art and design professionals and community representatives, and WMATA Architect.

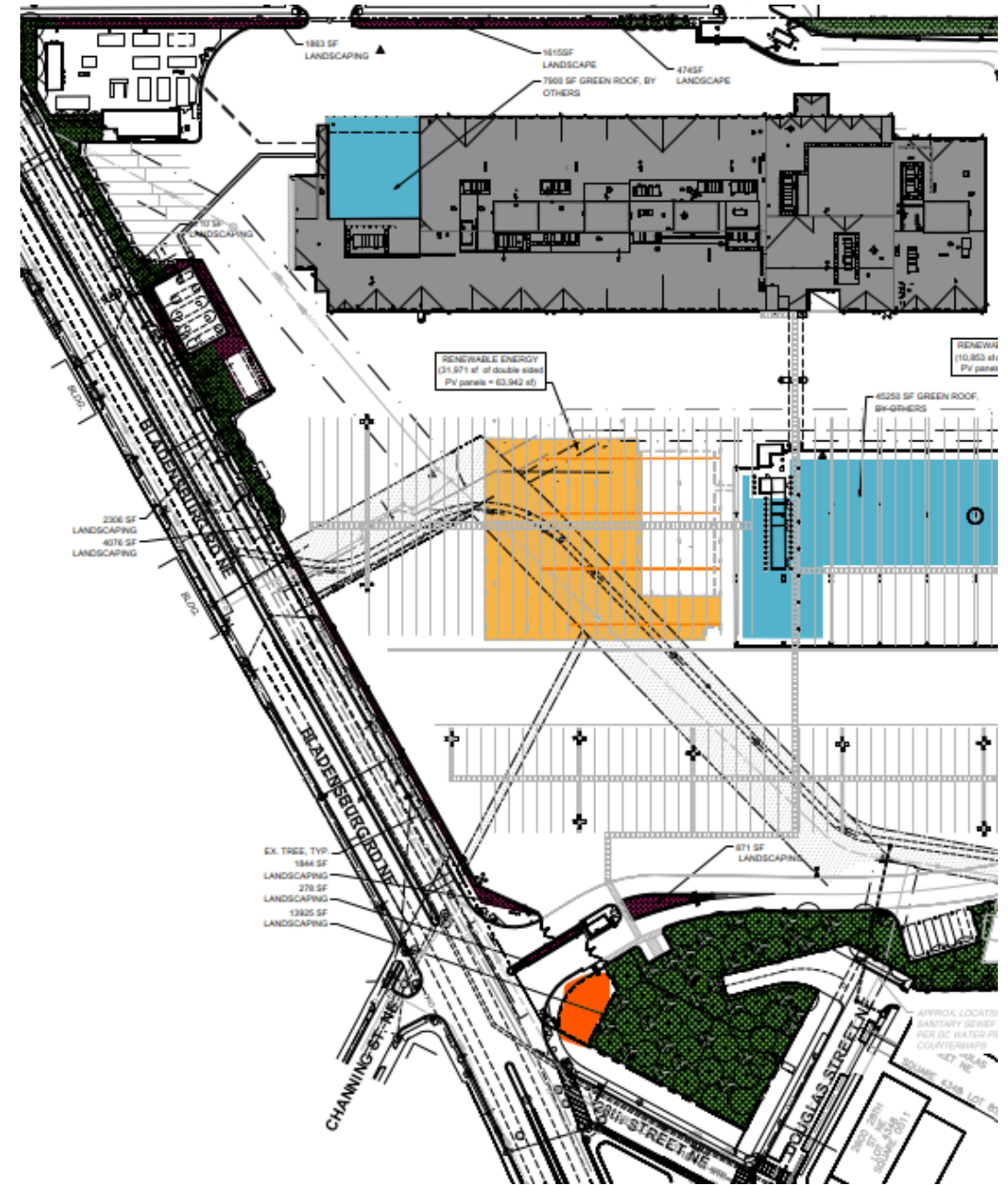

A Look Ahead: What to Expect At The Next Meeting



Outlook for Q3 2026

- Install electrical pathways
- East site utilities for lighting & Closed-Circuit Television (CCTV) pathways
- North trench drain
- Excavate, build out, & complete precast sandfilter (FS 2-5)
- Erection of precast structural elements for parking garage
- Douglas St. NE cul-de-sac utility work & installation of temporary turnaround
- Build out of permanent turnaround (i.e., hammerhead)
- Complete Comprehensive Site Assessment report for DOEE approval
- Form, reinforce, and place curb and gutter
- Preparation and grading of hardstand
- Begin topping slab activities in parking garage

Schedule

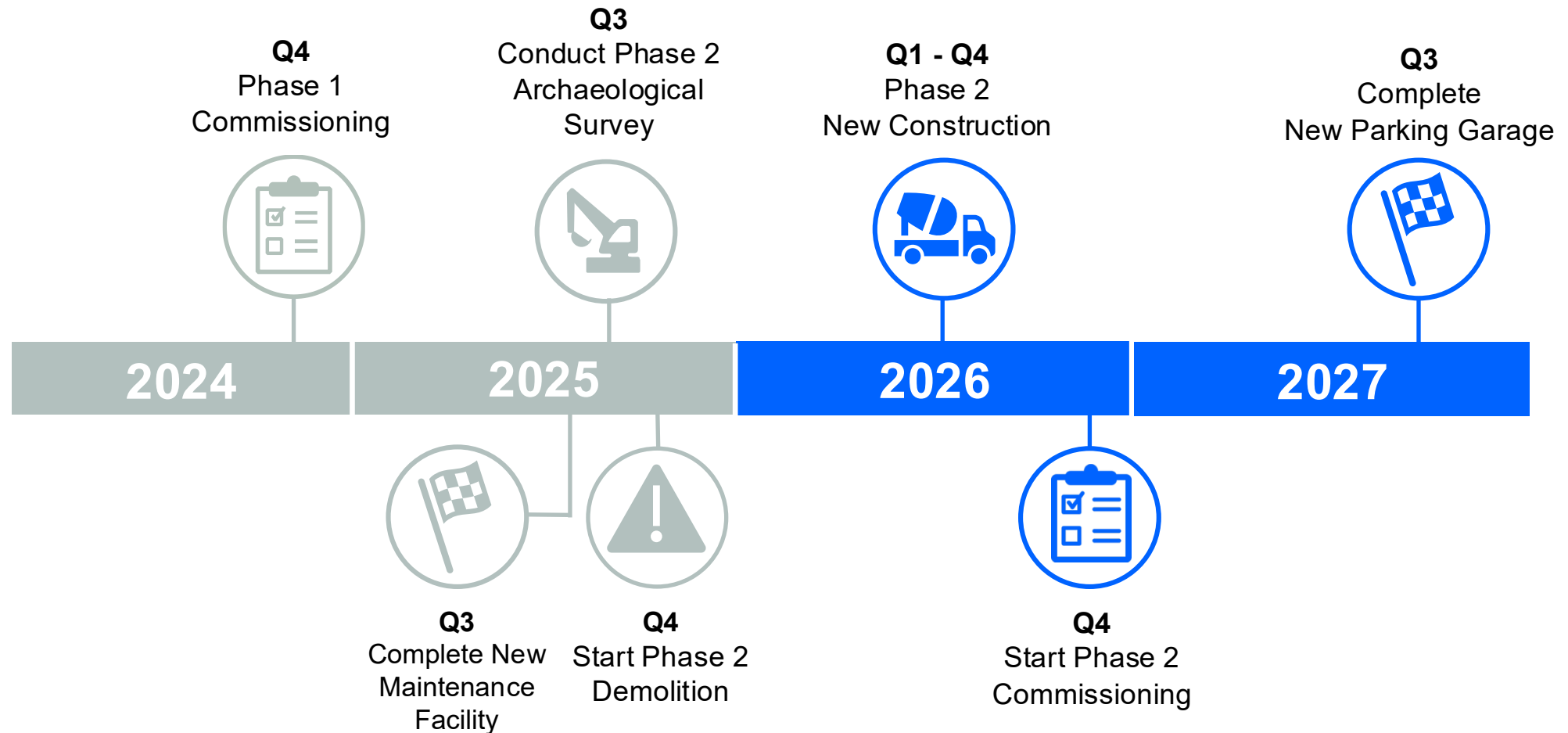

** As BEB design progresses, WMATA will also evaluate any impacts to the overall schedule. Schedule excludes BEB Construction.*

Community Engagement

Upcoming Events:

- **5/17: New** [wmata.com](https://www.wmata.com)
- **5/21:** Metro Discovery Day Info Session
- **5/31: New** metro pulse app
- **6/21:** Bus Service Improvements
- **6/23:** Metro Night at Nats Park
- **6/25-7/10:** Great American State Fair
 - 50th Pop-up Shop
- **7/6-9/6:** Red Line Major Construction
 - Visit [wmata.com/summer2026](https://www.wmata.com/summer2026) for more information

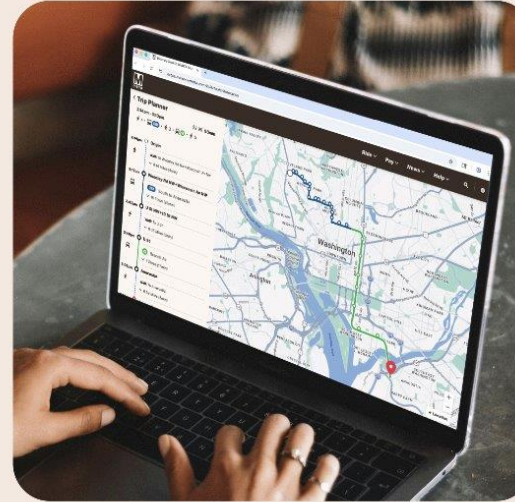

**rebuilt for
the way
you ride**

Arriving 5/17:
The new [WMATA.com](https://www.wmata.com)

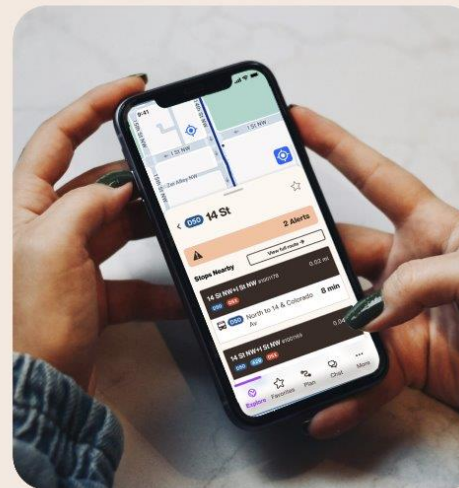

**tap into a
smarter
way to ride**

Arriving 5/31:
The new [metro pulse](https://www.metro-pulse.com) app



How to Follow-Up on the Project



**Sign Up For
Project Updates**

*BladensburgBusGarage@
wmata.com*



**Project
Website**

[wmata.com/
BladensburgBusGarage](http://wmata.com/BladensburgBusGarage)



Community Meetings

Next meeting:
Fall 2026
(Virtual Meeting)

Follow us on:



@MetroForward



@wmata



@MetroForward

Q&A Session



In-person

- Raise your hand if you'd like to ask a question



Virtual

- Type comments directly into the Q&A tool
- Raise your hand if you'd like to ask a question

Thank you!