



# Bus Service from Franconia-Springfield

**LEGEND** schematic map not to scale

**Rail Lines**  
 Metrorail Station and Line M  
 Commuter Rail Station

**Routes Operated by City/County Systems**  
 Fairfax Connector  
 Springfield Circulator  
 TAGS Routes

**Map Symbols**  
 Transit Hub  
 Park & Ride Lot  
 Airport  
 Hospital  
 College/University  
 Other Point of Interest

For all service providers, a thick line indicates frequent, seven-day service on the core route. Service levels vary on branches.

On all route types, a lightwashed badge indicates a route segment with limited or peak-only service hours.

On all route types, a black badge indicates a route's terminal point.

251A all-day service  
 251E limited service  
 25A



## BUS SERVICE AND BOARDING LOCATIONS

The table shows approximate time between buses in minutes; check schedules for full details

ROUTE	DESTINATION	BOARD AT BUS BAY	MONDAY TO FRIDAY				SATURDAY		SUNDAY	
			AM RUSH	MIDDAY	PM RUSH	EVENING	DAY	EVENING	DAY	EVENING
<b>SPRINGFIELD CIRCULATOR – TAGS</b>										
350	Springfield Town Center-Hilton	C	12-15	15-20	15	--	--	--	--	--
351	NVCC Medical College-TSA	D	15-22	--	15-20	--	--	--	--	--
352	Springfield Town Center-TSA	D	--	15-20	--	--	--	--	--	--
353	Metro Park-Inova HealthPlex	D	15	15-20	15	--	--	--	--	--
<b>FAIRFAX CONNECTOR</b>										
231	Van Dorn St M (Counterclockwise)	K	30-35	--	30-32	60	--	--	--	--
232	Van Dorn St M (Clockwise)	K	30	--	30-35	60	--	--	--	--
301	Huntington M	L	30-60	--	30-35	--	--	--	--	--
305	Lorton VRE Station	L	30**	--	20-30	40	--	--	--	--
308	Mt Vernon Hospital	L	30	40	30	45	45	45	--	--
310	Rolling Valley Park & Ride	F	20	30	20	30	30	30	60	60
310	Huntington M	H	20	30	20	60	30	30	60	60
321	Van Dorn St M (Counterclockwise)	H	30	30	30	30	30	30	60	60
322	Van Dorn St M (Clockwise)	F	30	30	30	30	30	30	60	60
340	Patriot Ridge-Saratoga	J	--	45-50#	--	50	--	--	--	--
341	Patriot Ridge-Saratoga	J	25-30	--	20-30	--	--	--	--	--
334	Newington-US Army Museum	J	25-30	--	30	--	--	--	--	--
335	Fort Belvoir	J	20-30	--	20-35	--	--	--	--	--
371	Lorton Park & Ride	G	--	30-35	--	45-50#	35^	50	--	--
401	Tysons West*Park	C	13-17	15-20	15-20	30	25-30	30-50	25-30	30-50
494	Tysons M	L	25-30	2 trips	25-30	--	--	--	--	--
<b>BESTBUS</b>		M*	For schedule information visit <a href="http://www.bestbus.com">www.bestbus.com</a>							
<b>OMNIRIDE</b> Omniride Transit Ctr-Potomac Mills		B	For schedule information visit <a href="http://www.prcttransit.org">www.prcttransit.org</a>							
<b>GREYHOUND</b>		A	For schedule information visit <a href="http://www.greyhound.com">www.greyhound.com</a>							

\* Trips end at Springfield  
 \*\* 305 does not serve Gannett Road Park & Ride in the AM  
 # Midday trips serve Patriot Ridge  
 M Please note that stop letter is not displayed at the stop

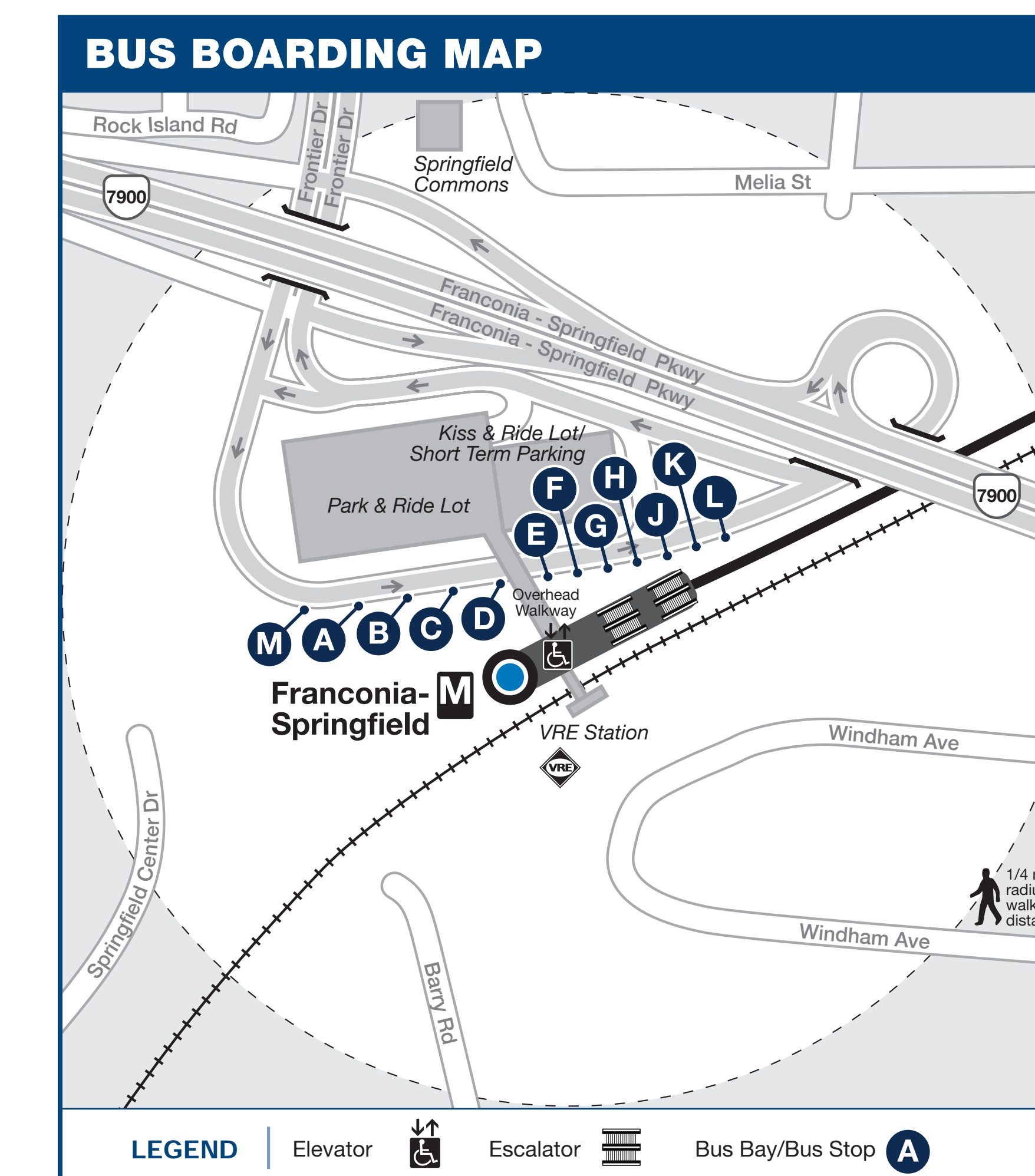

**metroAlerts**

Through MetroAlerts, you can be notified of Metro service disruptions via email or text messages. MetroAlerts can be sent to computers, cellular phones, pagers or personal digital assistants capable of receiving data. MetroAlerts are limited to 140 characters to prevent them from being truncated when received as text messages. If further information on the incident is available, it is published on the website and a link to that information is included in the MetroAlert.

**KNOW MORE. KNOW FIRST.**  
 Sign up today at [wmata.com/MetroAlerts](http://wmata.com/MetroAlerts)

**information** [wmata.com](http://wmata.com) | 202-637-7000 | 202-638-3780  
 busETA and General Inquiries

Para busETA y información general, llame al 202-637-7000 (TTY 202-638-3780) o visite [wmata.com](http://wmata.com).

경보나 busETA 또는 연이 지체 관련 문의는 202-637-7000 (TTY 202-638-3780) 으로 전화하십시오. 스페어 언어 문의는 #을 누르고, 기타 언어 관련 문의는 88을 누른 후 #을 누르십시오. 또는 [wmata.com](http://wmata.com) 을 방문하십시오.

**metroAlerts**  
 Sign up today at [wmata.com/MetroAlerts](http://wmata.com/MetroAlerts)

**Metro is accessible.**  
 Metro es accesible.  
 메트로는 접속 가능합니다.

