

# WASHINGTON METROPOLITAN AREA TRANSIT AUTHORITY



## FARRAGUT NORTH AND FARRAGUT WEST IMPROVEMENT CONCEPTS

FEBRUARY 2015

KGP design studio



(This page intentionally left blank)

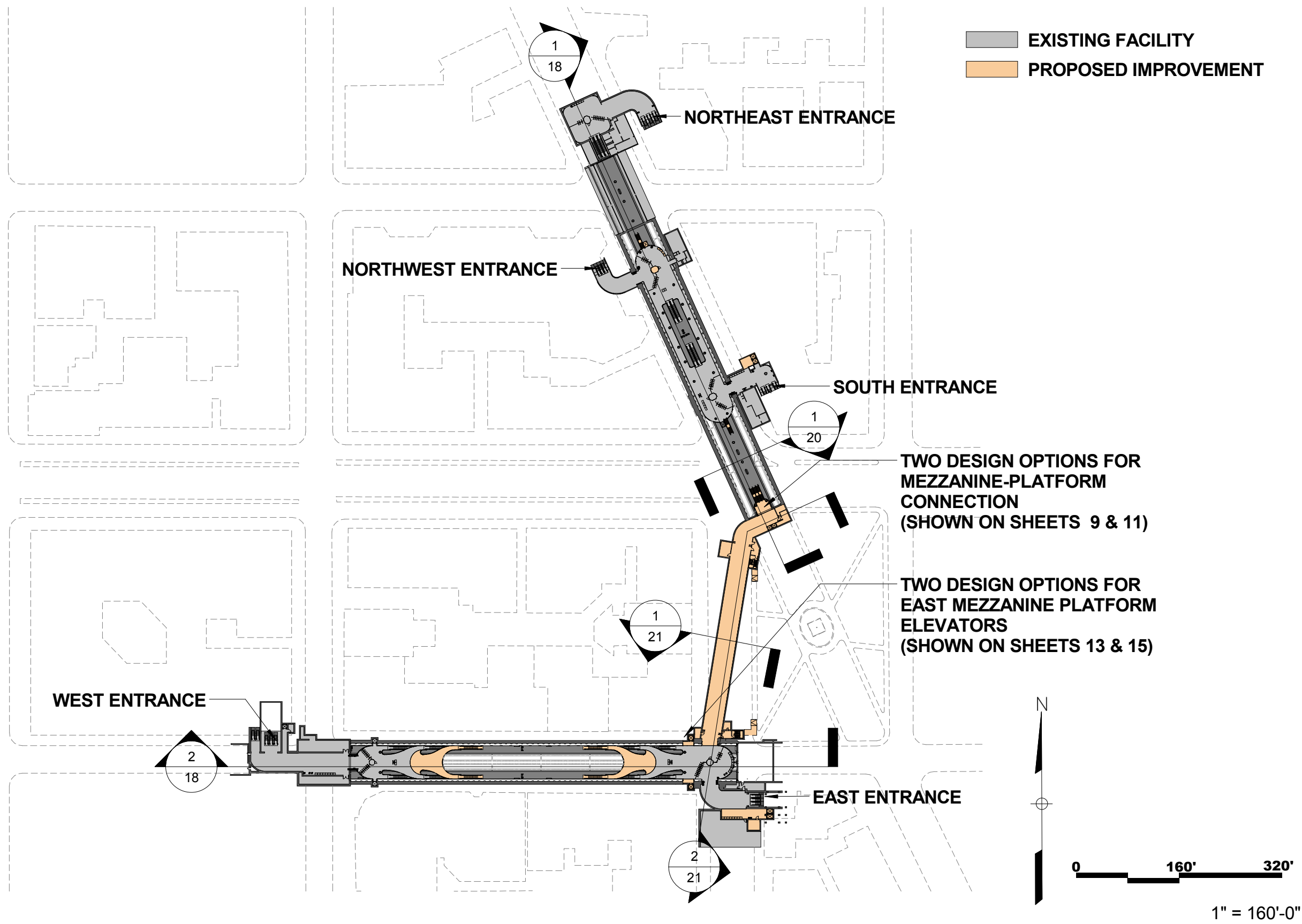

**Farragut North and Farragut West Improvement Concepts**

KGP design studio

Station Overview - Plan View

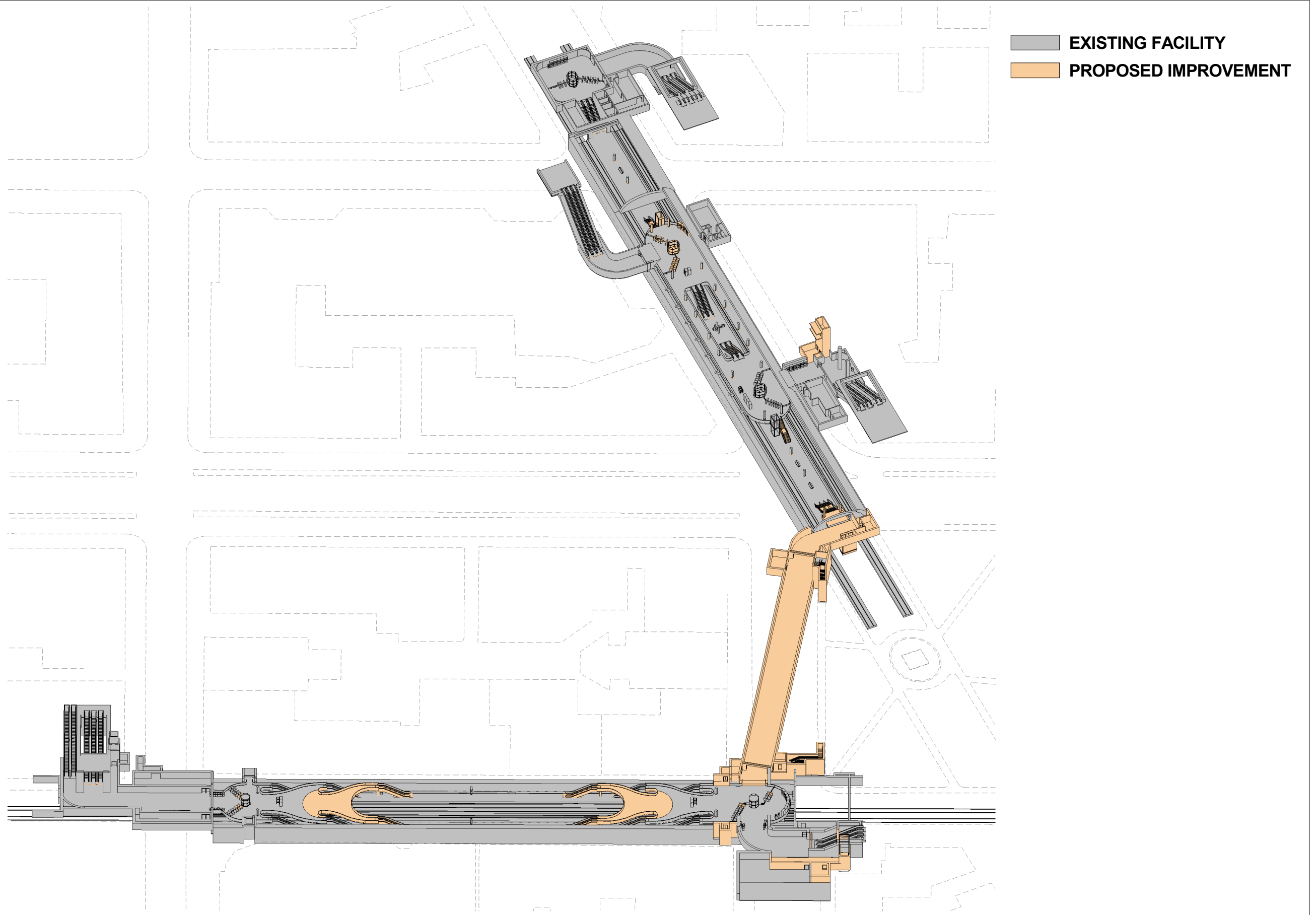

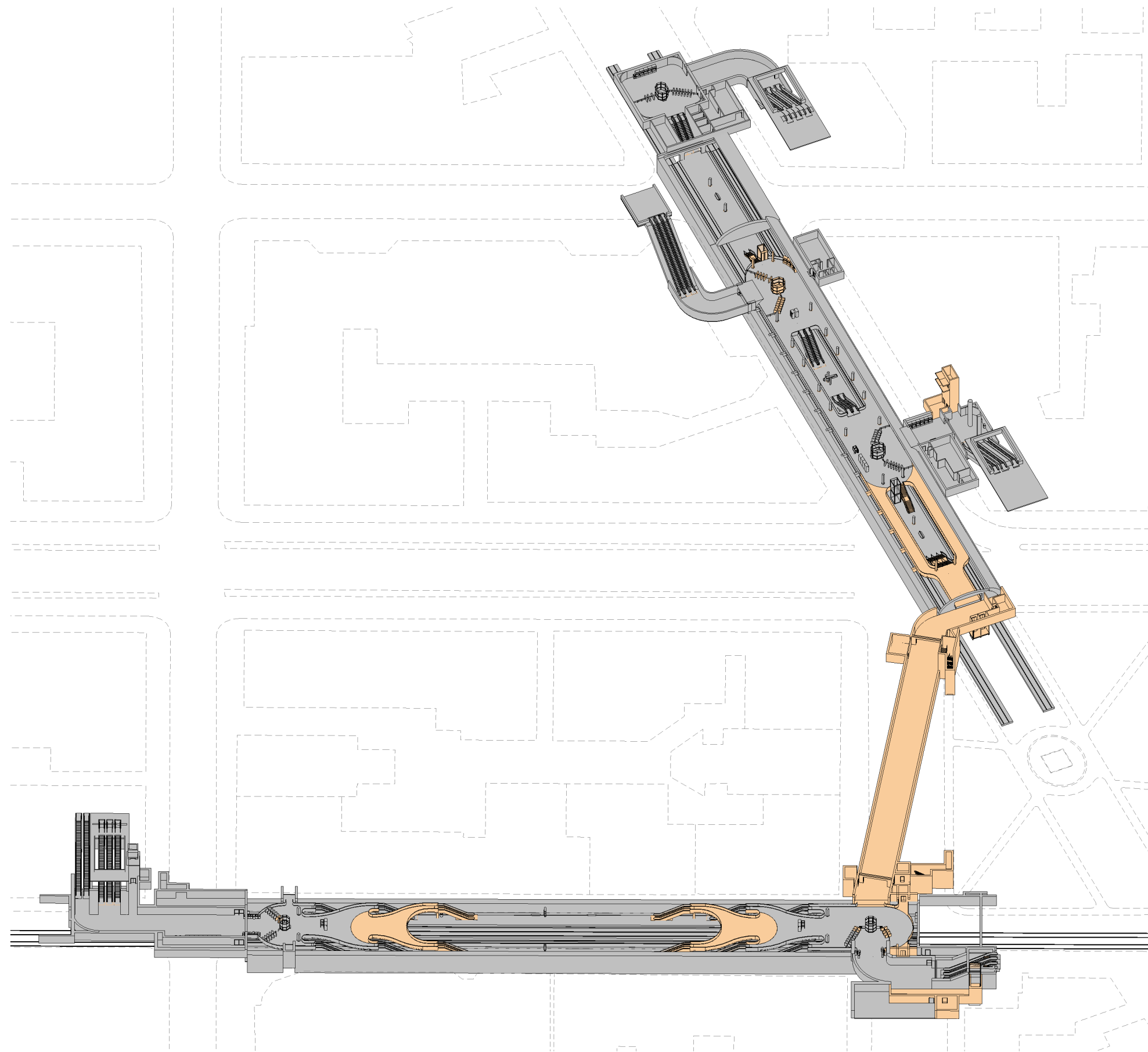

EXISTING FACILITY  
PROPOSED IMPROVEMENT



# Farragut North and Farragut West Improvement Concepts

KGP design studio

Station Overview - Axonometric View with Option 2 at each Station

February 2015

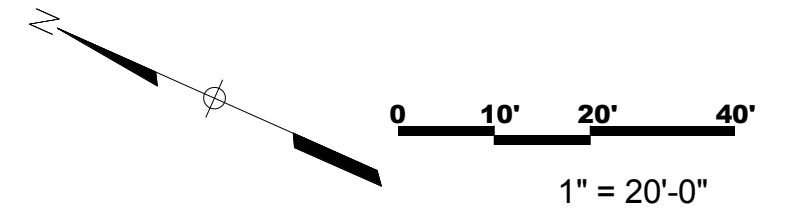
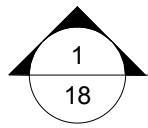
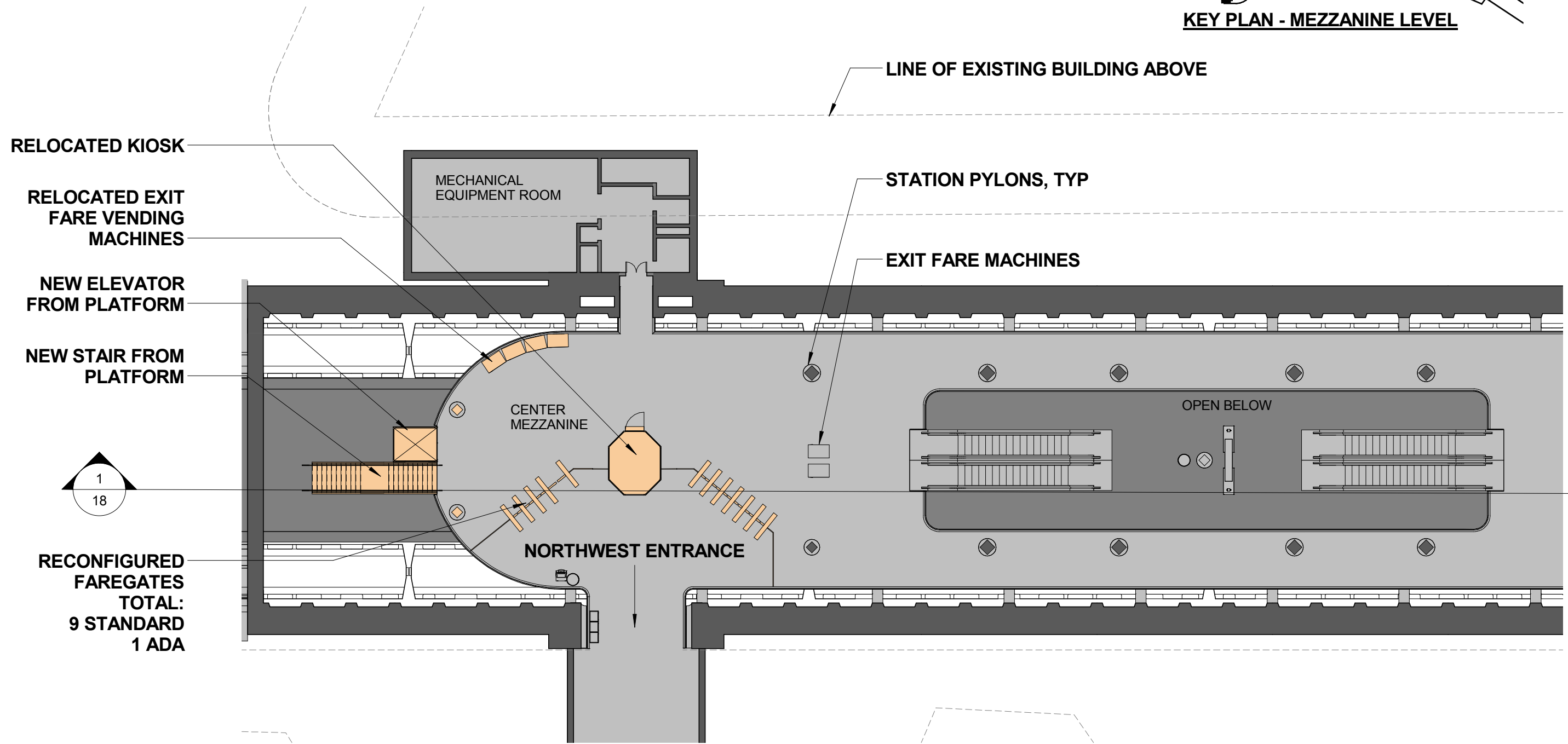
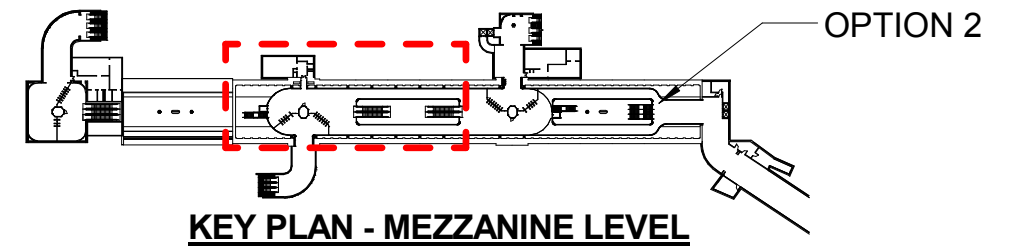

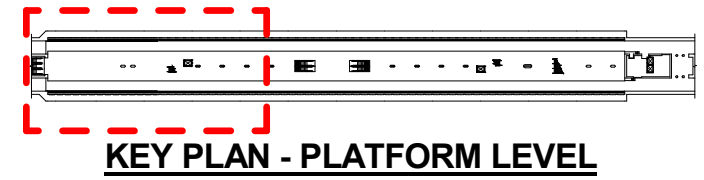

SERVICE ROOMS ABOVE  
 MEZZANINE ABOVE  
 NEW ELEVATOR TO CENTER MEZZANINE  
 NEW STAIR TO CENTER MEZZANINE

ESCALATORS TO  
 NORTH MEZZANINE

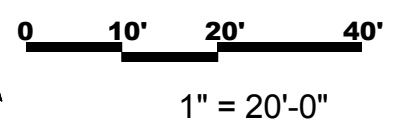
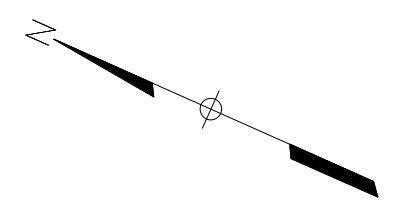
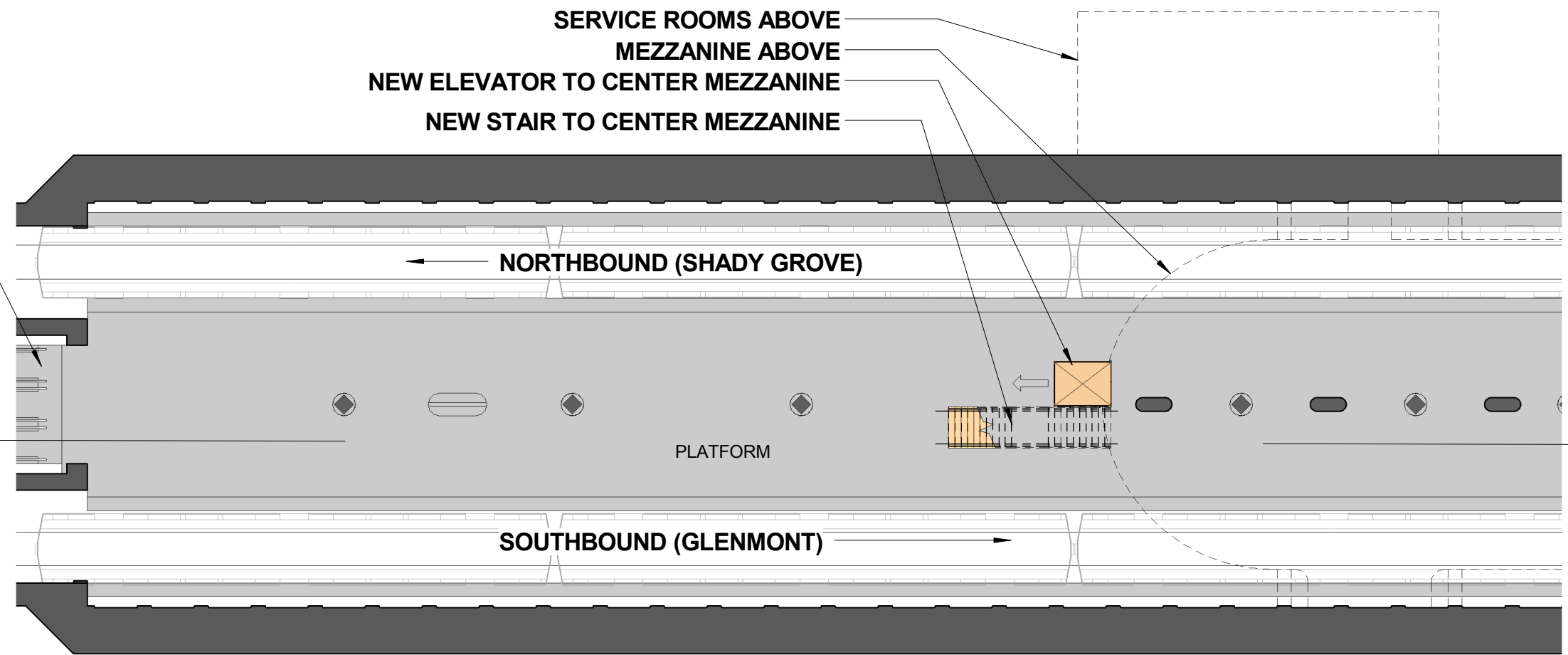
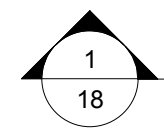

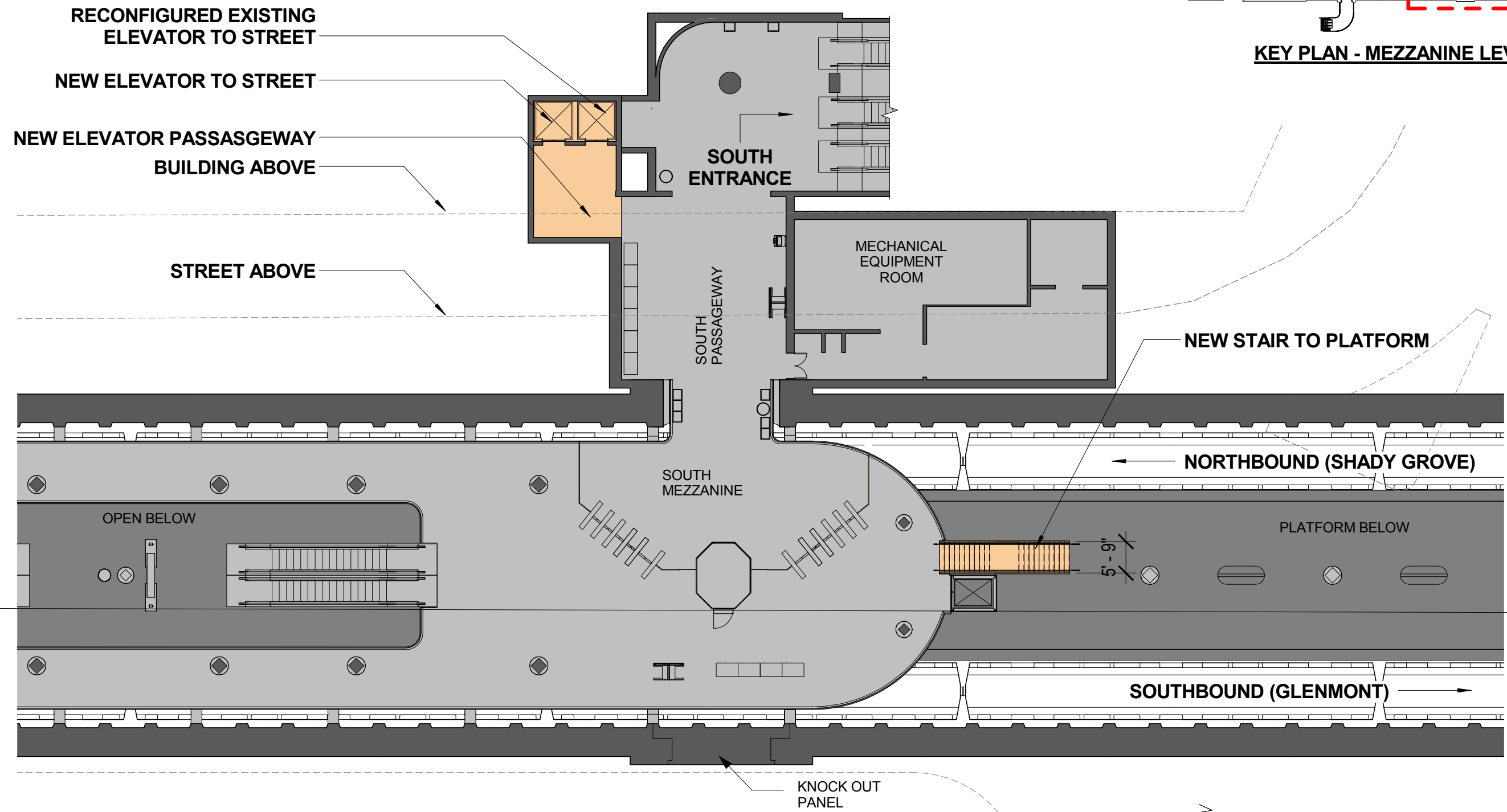
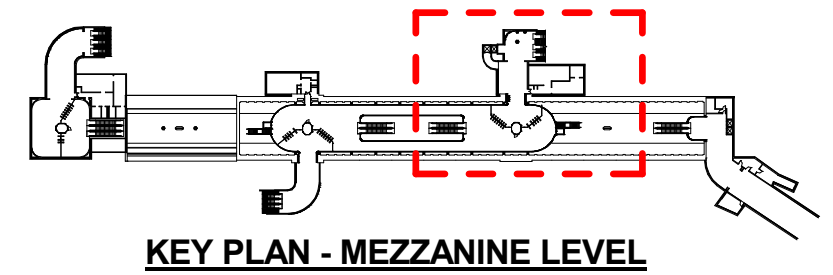

1  
18

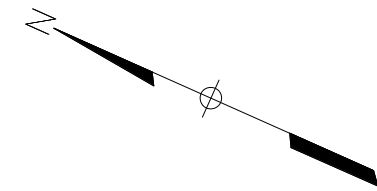

0 10' 20' 40'  
1" = 20'-0"





PROPOSED INTERVENTION  
OF EXISTING BUILDING FOR  
NEW AND RECONFIGURED  
ELEVATOR

RECONFIGURED  
EXISTING ELEVATOR  
TO MEZZANINE

NEW ELEVATOR TO  
MEZZANINE

SOUTH ENTRANCE  
ESCALATORS TO  
MEZZANINE

EXISTING BUILDING

KEY PLAN - STREET LEVEL

CONNECTICUT AVE

K STREET

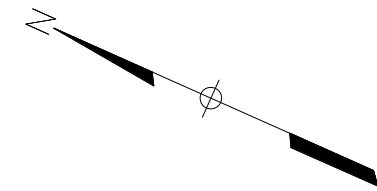

0 10' 20' 40'

1" = 20'-0"



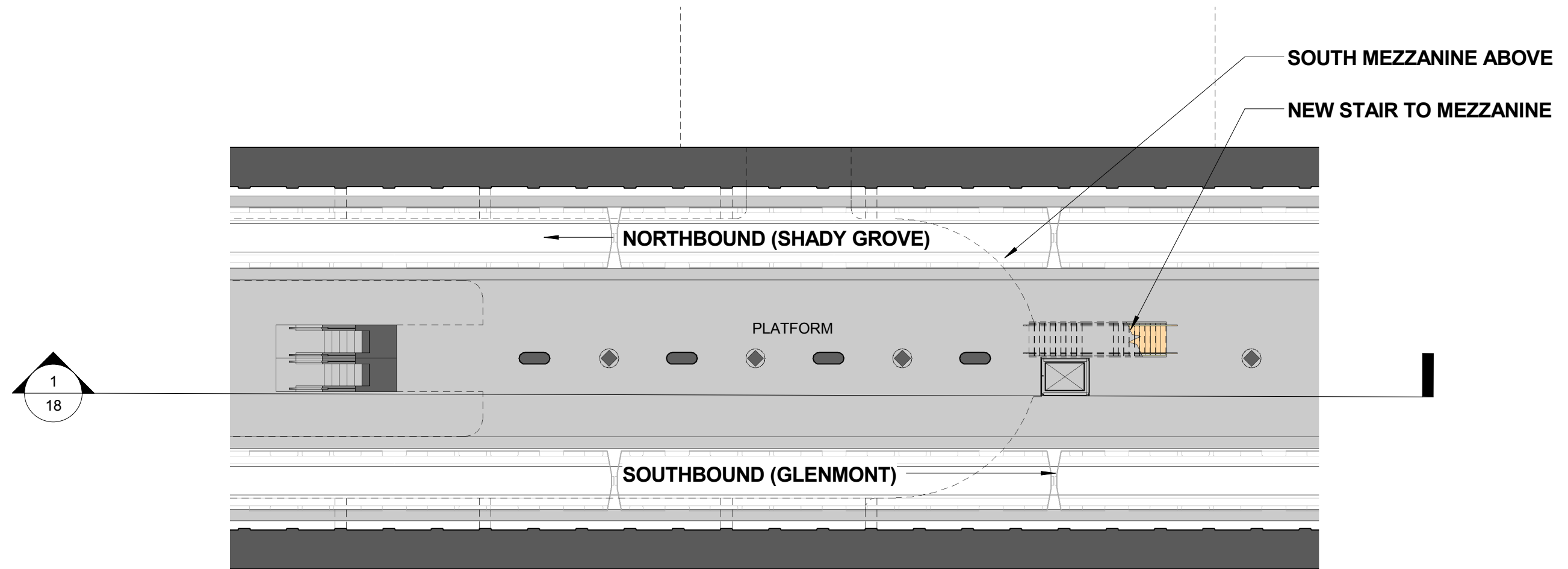
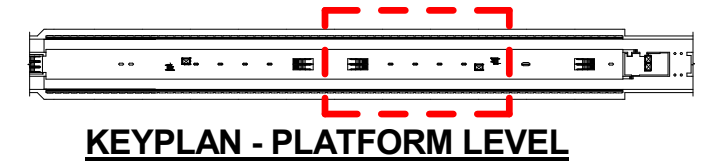

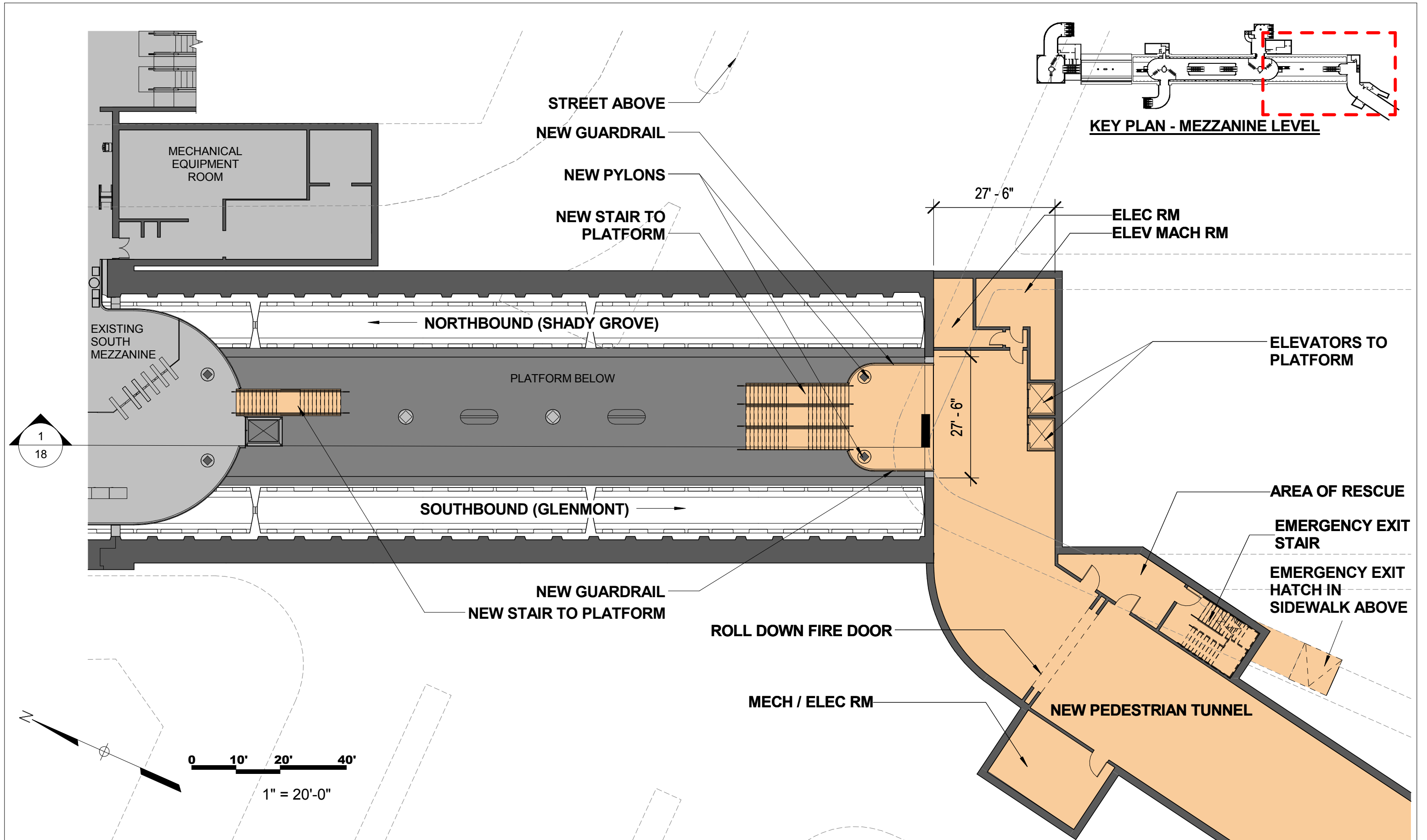

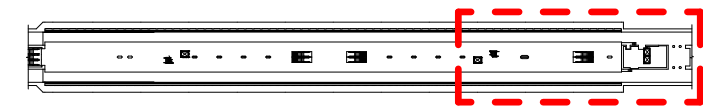

**KEYPLAN - PLATFORM LEVEL**

**NEW STAIR TO SOUTH MEZZANINE**

**NEW STAIR TO PEDESTRIAN TUNNEL**

**NEW MEZZANINE TO TUNNEL CONNECTION ABOVE**

**NEW MEZZANINE EXTENSION COLUMN**

**NEW ELEVATORS TO TUNNEL**

**EXISTING SERVICE ROOM**

**NEW ELEVATOR PASSAGEWAY**

**NORTHBOUND (SHADY GROVE)**

**SOUTHBOUND (GLENMONT)**

**PLATFORM**

21'-3"

6'-0"  
15'-0"  
6'-0"

14'-0"

1  
18

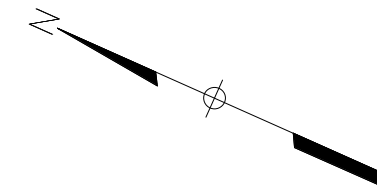

0 10' 20' 40'

1" = 20'-0"



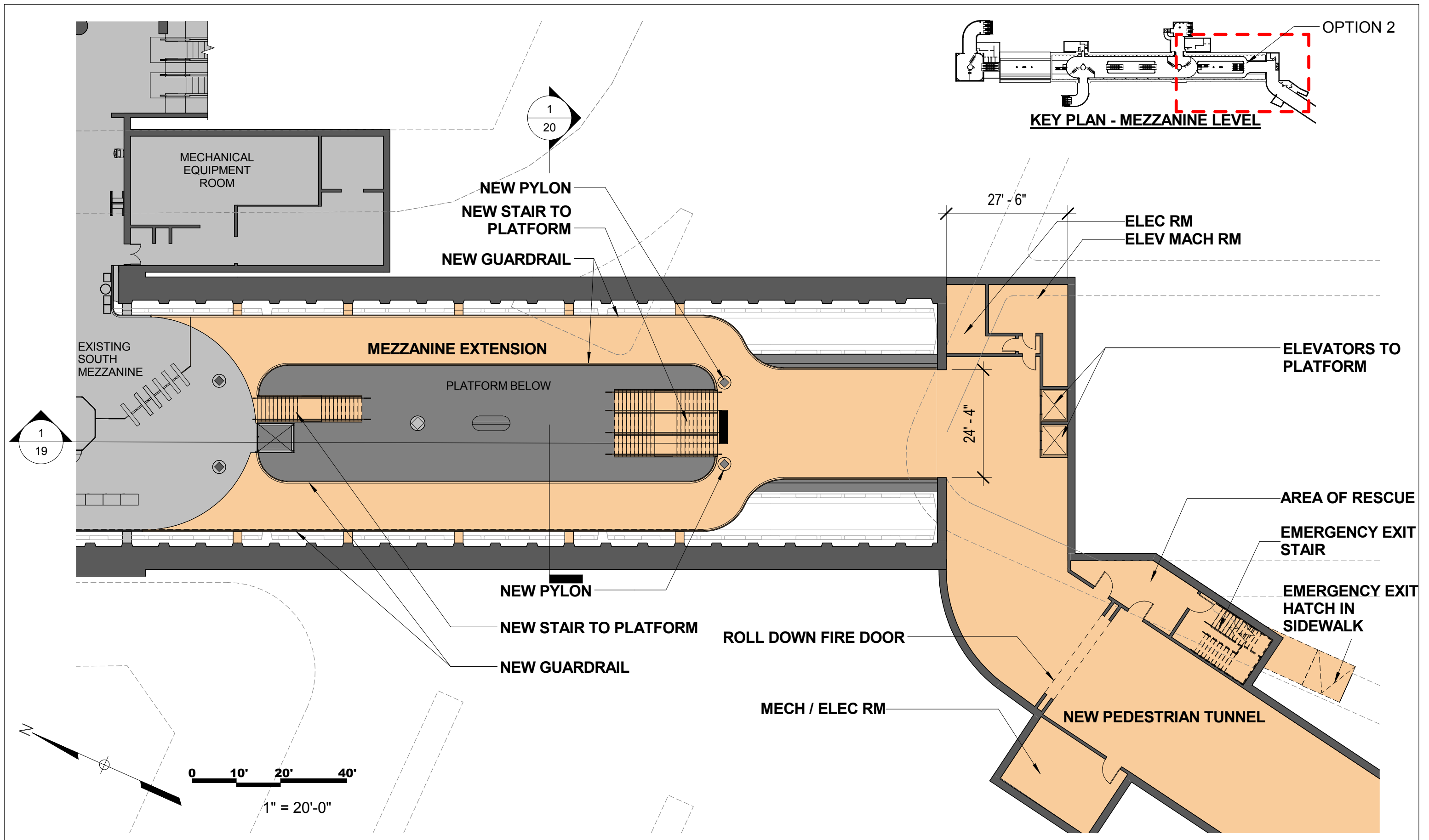

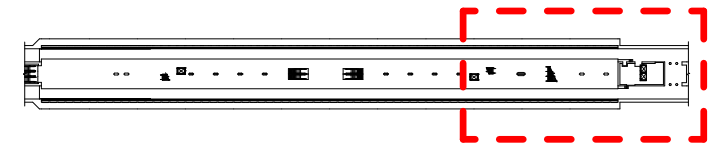

**KEY PLAN - PLATFORM LEVEL**

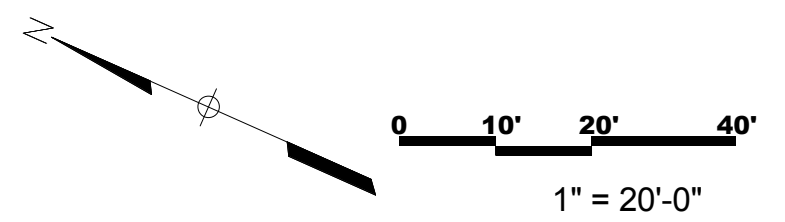
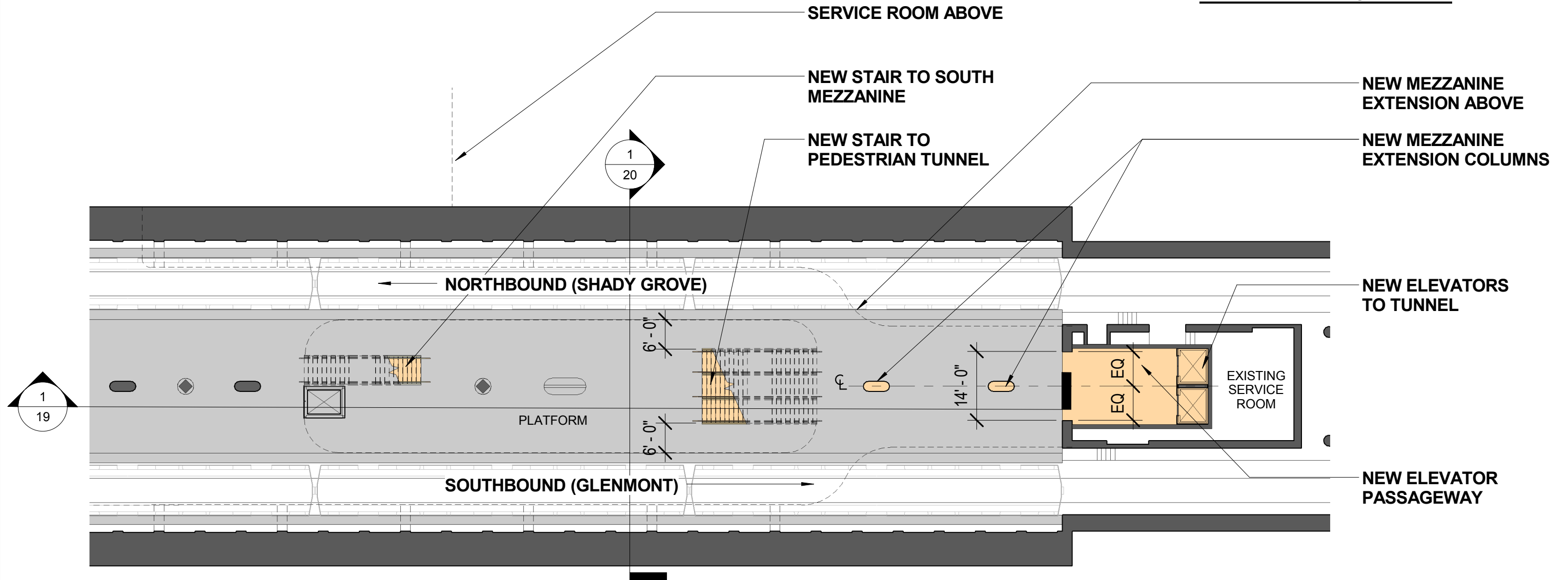

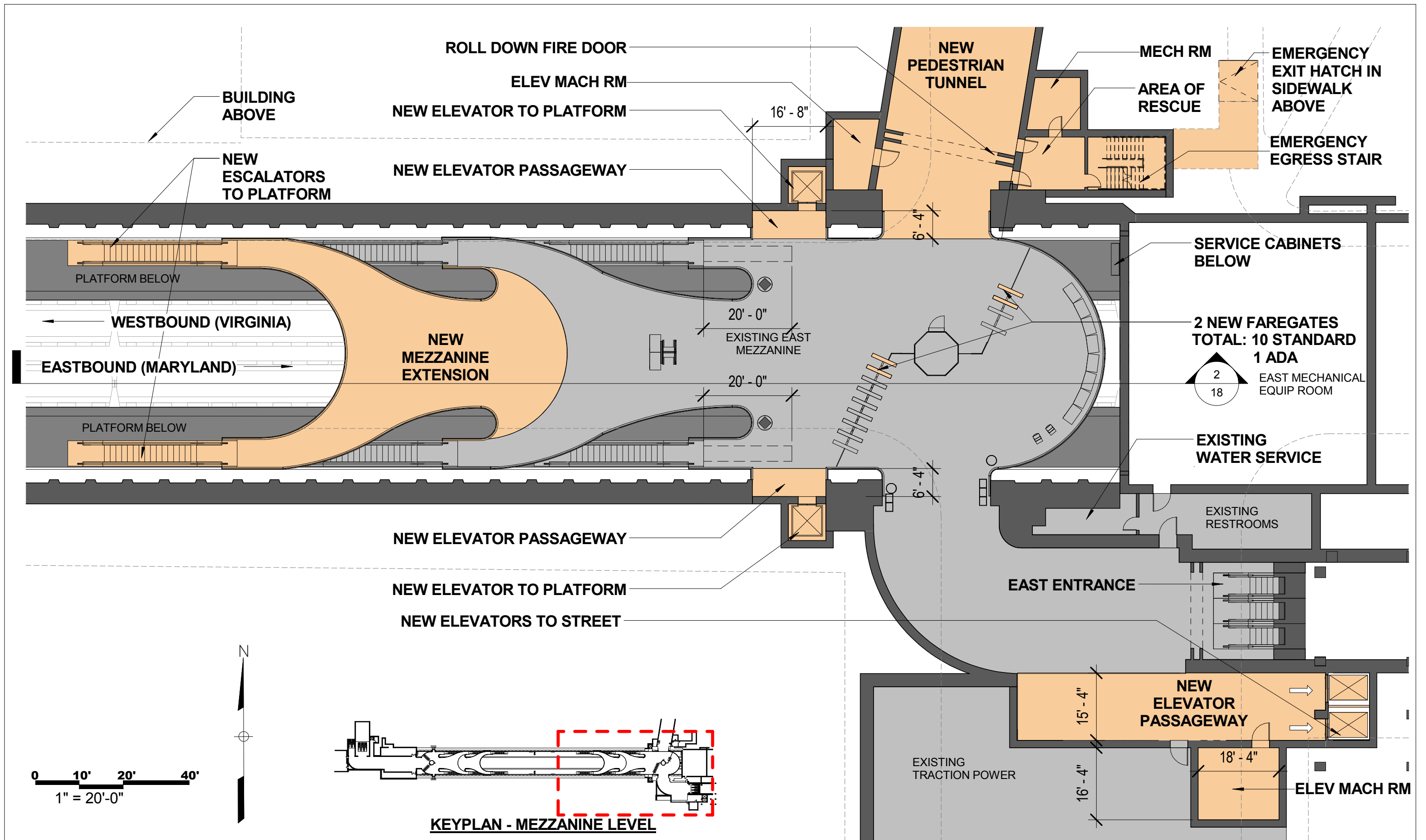

NEW PEDESTRIAN TUNNEL ADDITION ABOVE

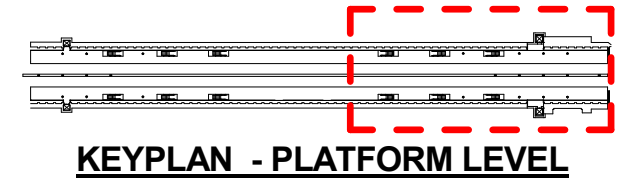

NEW ELEVATOR TO MEZZANINE  
NEW ELEVATOR PASSAGEWAY

16' - 8"

NEW ESCALATORS TO MEZZANINE

6' - 7"

PLATFORM

WESTBOUND (VIRGINIA)

EASTBOUND (MARYLAND)

PLATFORM

6' - 7"

NEW MEZZANINE COLUMNS

NEW ELEVATOR PASSAGEWAY  
NEW ELEVATOR TO MEZZANINE

MEZZANINE ABOVE

STREET ABOVE

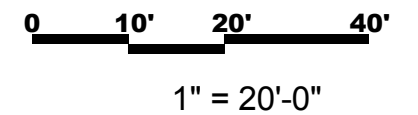
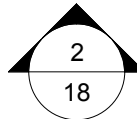



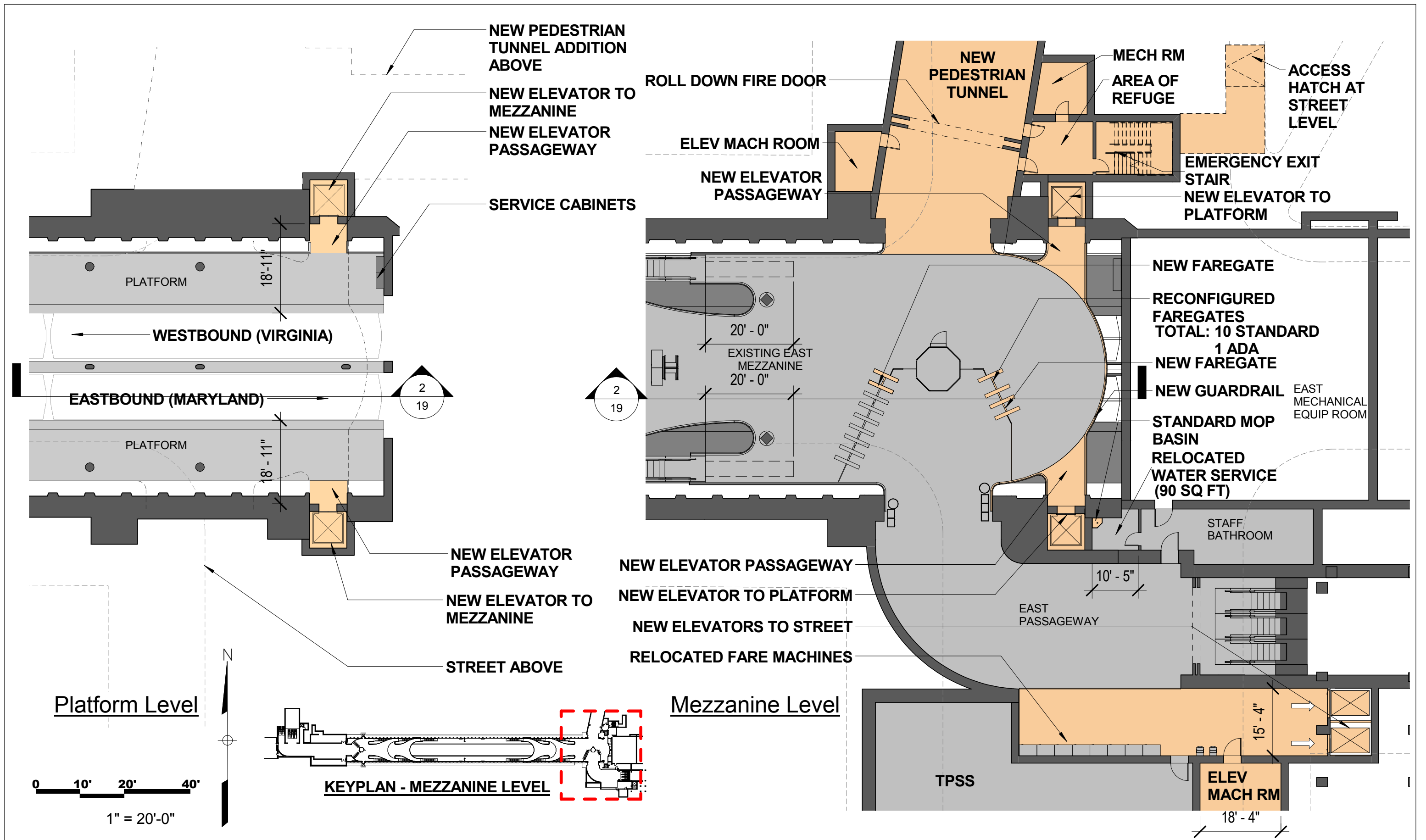

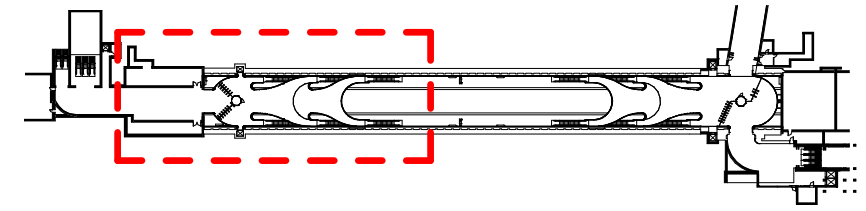

**KEYPLAN - MEZZANINE LEVEL**

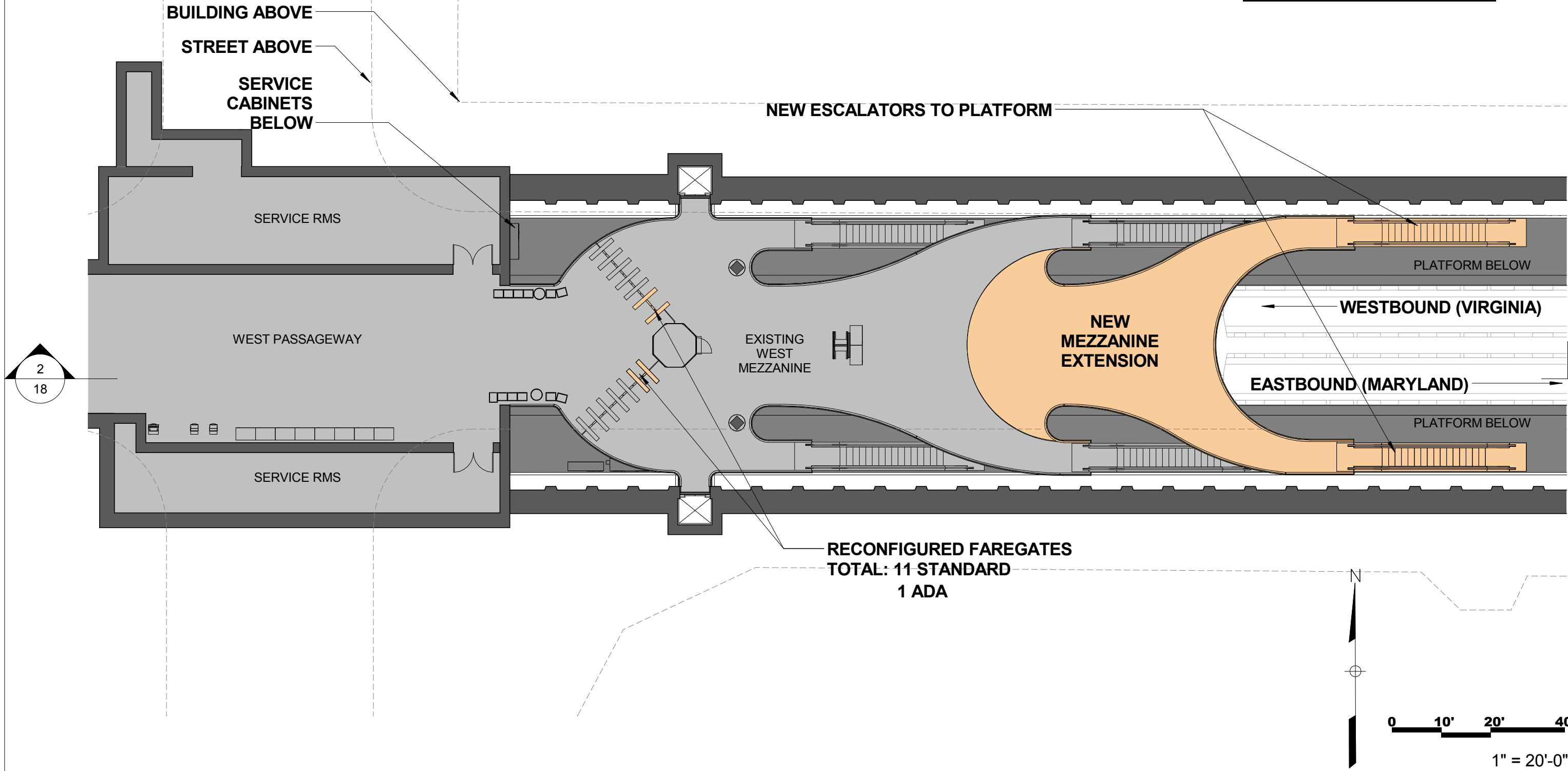

2  
18



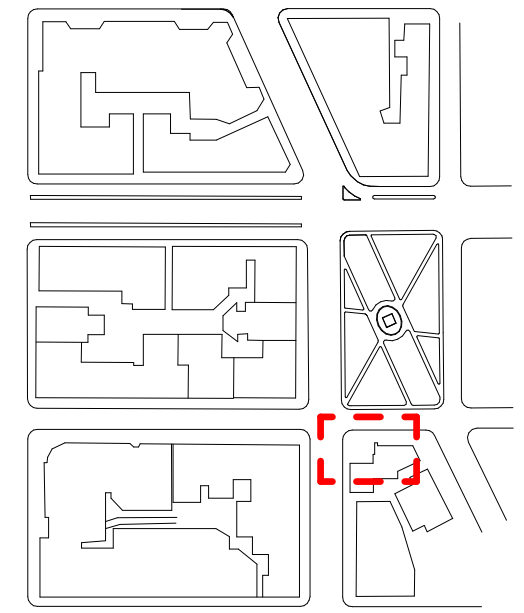

**KEYPLAN - SITE**

I STREET

CONNECTICUT AVE

EAST ENTRANCE

EXISTING BUILDING

EL=+/- 68.0'

NEW ELEVATORS TO MEZZANINE (7'-4"X10'-0")

EXISTING SLOPE REMOVED AS PART OF NEW ELEVATOR IMPROVEMENTS TO ENTRANCE

17TH STREET



1" = 20'-0"



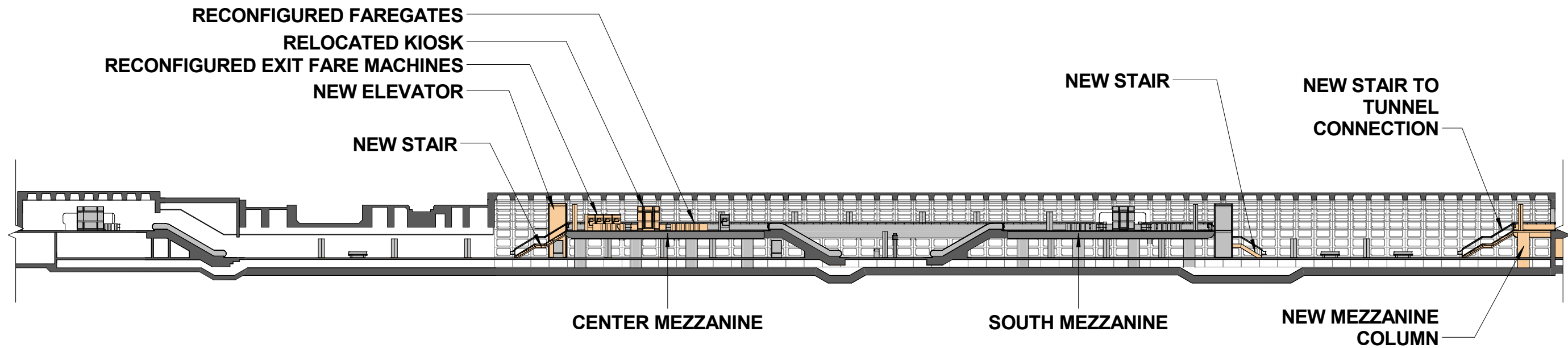

**1** FARRAGUT NORTH - LONGITUDINAL SECTION OPTION 1  
 1" = 50'-0"  
 REF. SHEET: 01

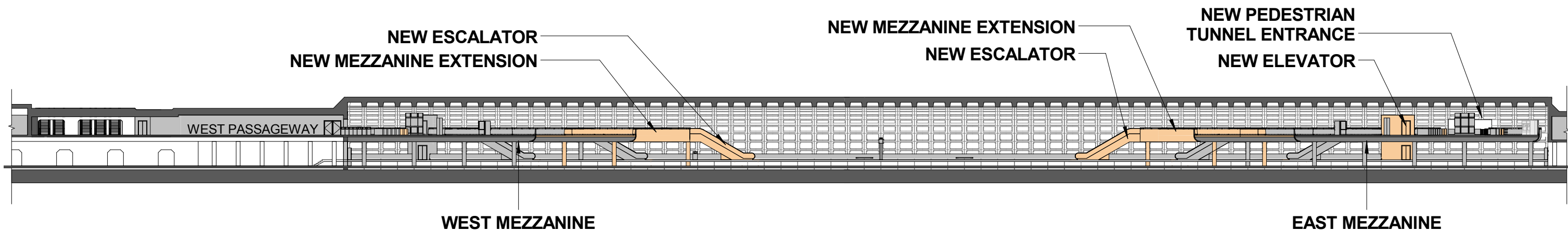

**2** FARRAGUT WEST - LONGITUDINAL SECTION OPTION 1  
 1" = 50'-0"  
 REF. SHEET: 01



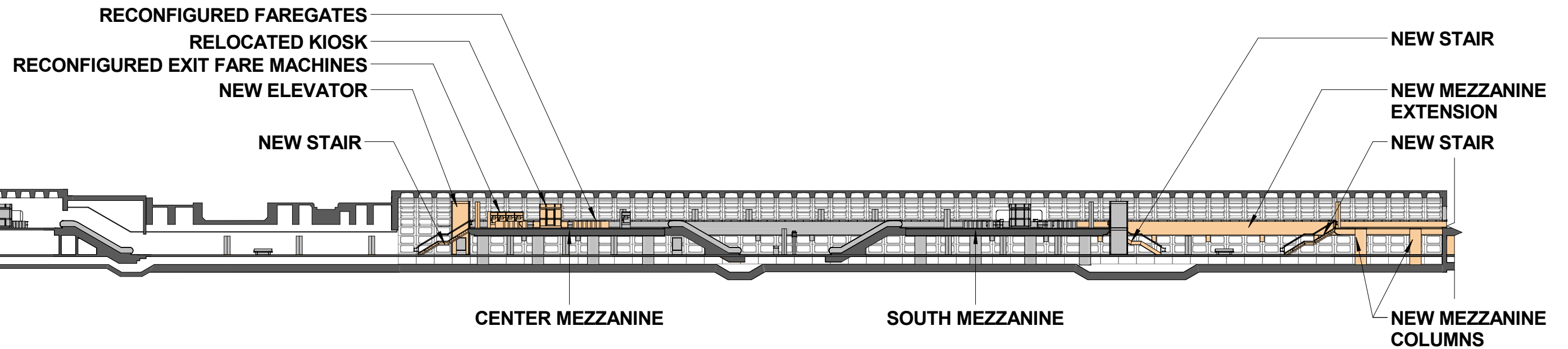

**1** FARRAGUT NORTH - LONGITUDINAL SECTION OPTION 2  
 1" = 50'-0"  
 REF. SHEET: 11

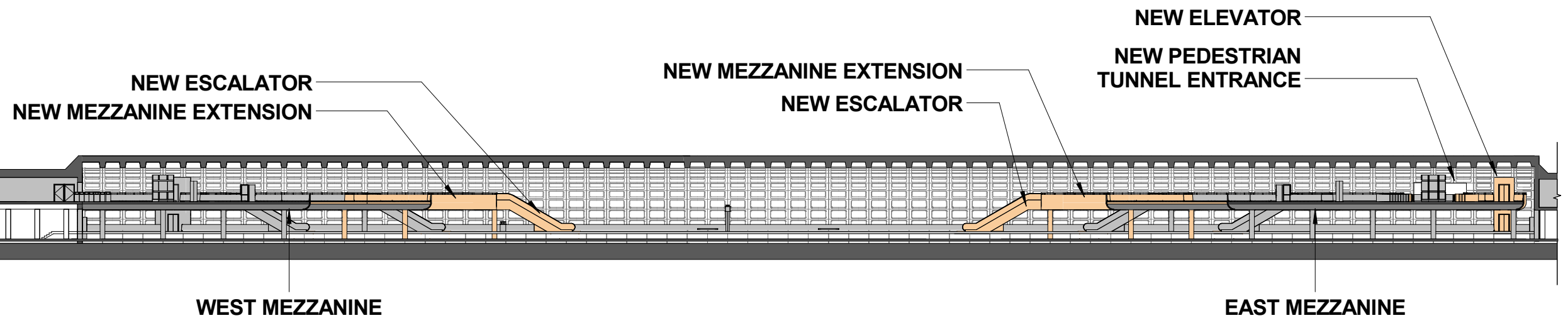

**2** FARRAGUT WEST - LONGITUDINAL SECTION OPTION 2  
 1" = 50'-0"  
 REF. SHEET: 15



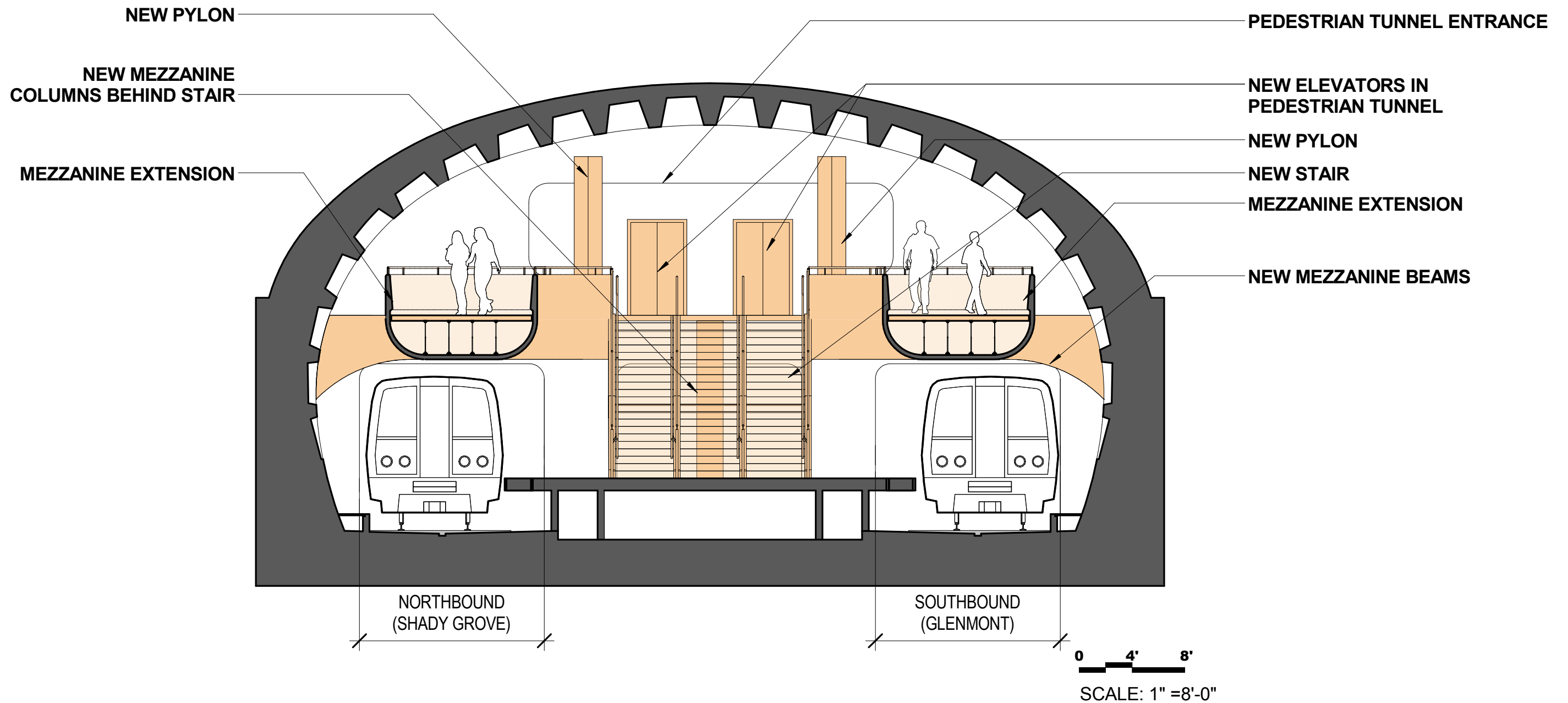

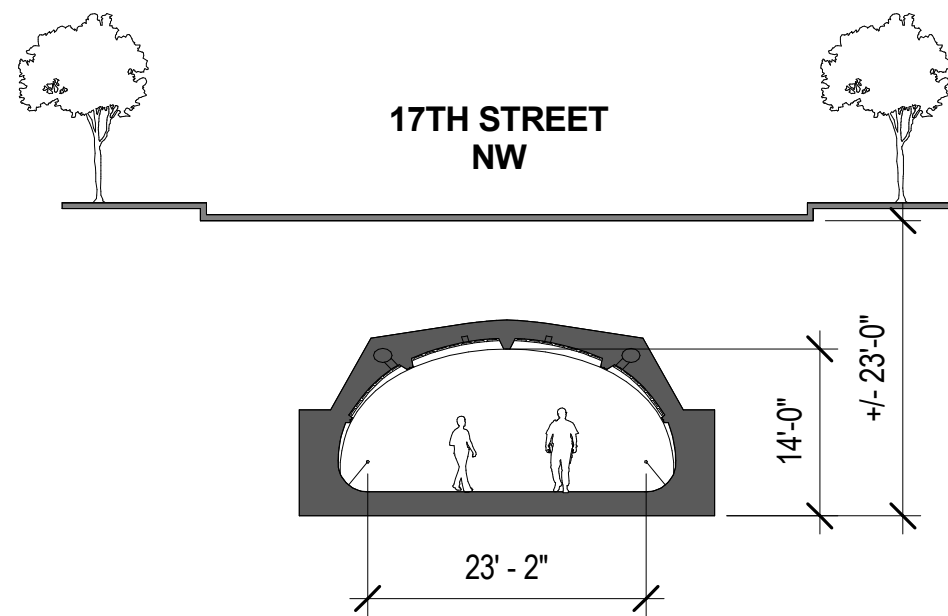

**1** CROSS SECTION  
 1/16" = 1'-0"  
 REF. SHEET: 01

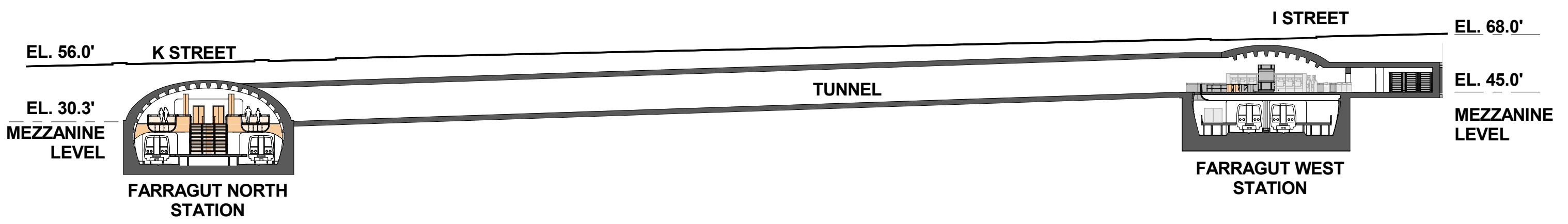

**2** LONGITUDINAL SECTION  
 1" = 40'-0"  
 REF. SHEET: 01

